

THE BALMAIN  
BOAT COMPANY

## You will have received

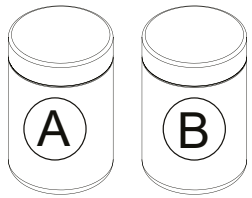

Epox-E-Glue  
Part A: Resin/Part B: Hardener

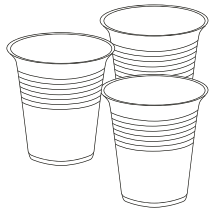

Plastic cups

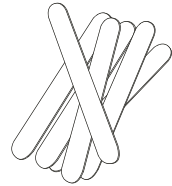

Paddle Pop Sticks



Screws  
25mm (1 inch) & 16mm ( $\frac{5}{8}$  inch)

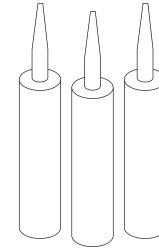
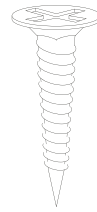

Sikaflex

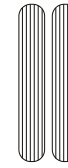

Dowels

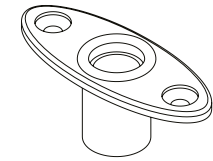

Rowlocks

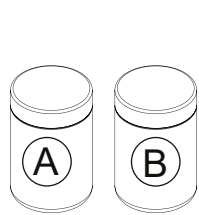

Mix only when ready to use

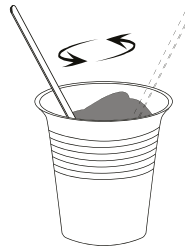
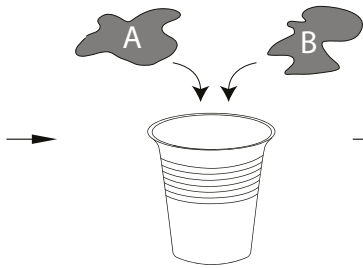

Mix thoroughly to an even tone  
with paddle pop sticks provided

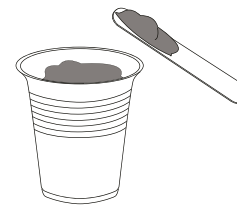

Use paddle pop sticks  
for application

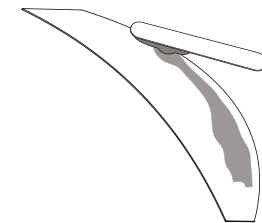

Smear evenly along surfaces  
leaving no gaps

## You will need to provide

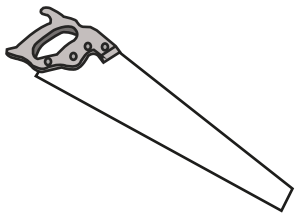

Metal Hand saw

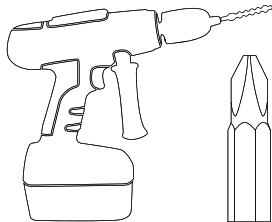

Drill with 2.5mm drill bit  
and phillips head driver bit

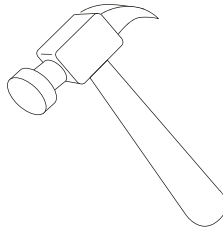

Hammer

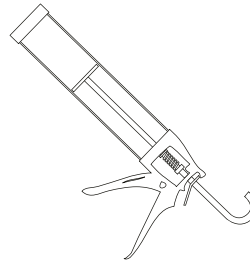

Caulking Gun



Mineral Turpentine

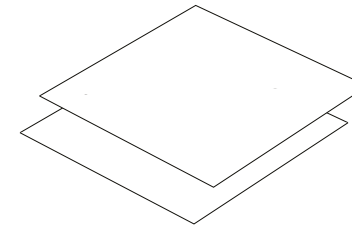

Sandpaper



THE BALMAIN  
BOAT COMPANY

## IMPORTANT:

SAND THE EDGES OF EACH PART TO REMOVE ROUGH EDGES

ASSEMBLE THE BOAT ONCE WITHOUT GLUE AND NAILS TO TEST  
FIT OF ALL COMPONENTS

CLEAN UP EXCESS GLUE IMMEDIATELY AS IT IS HARD TO REMOVE  
WHEN DRY



THE BALMAIN  
BOAT COMPANY

### STEP 1

NOTE: APPLY GLUE TO GREY AREAS INDICATED

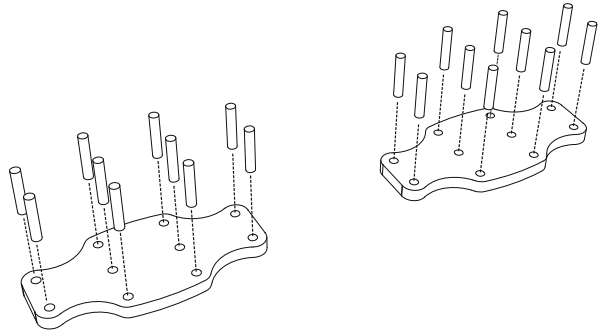
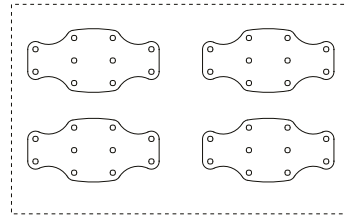

### STEP 2

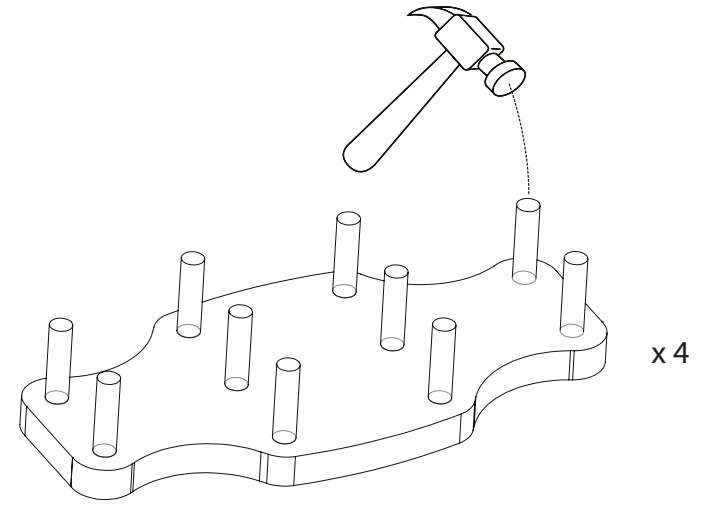

### STEP 3

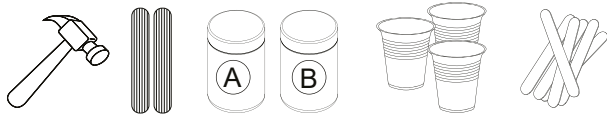
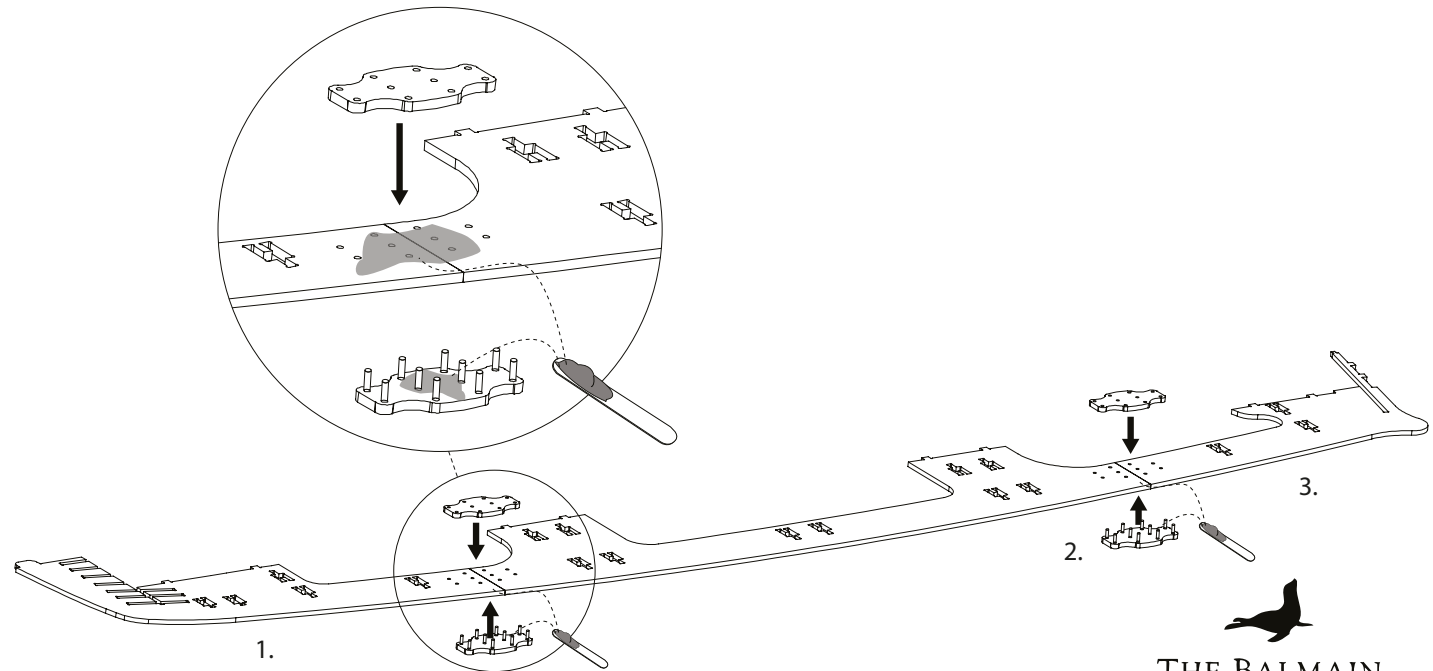
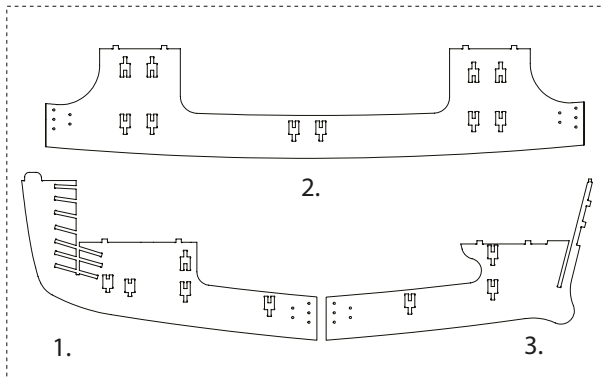

STEP 4

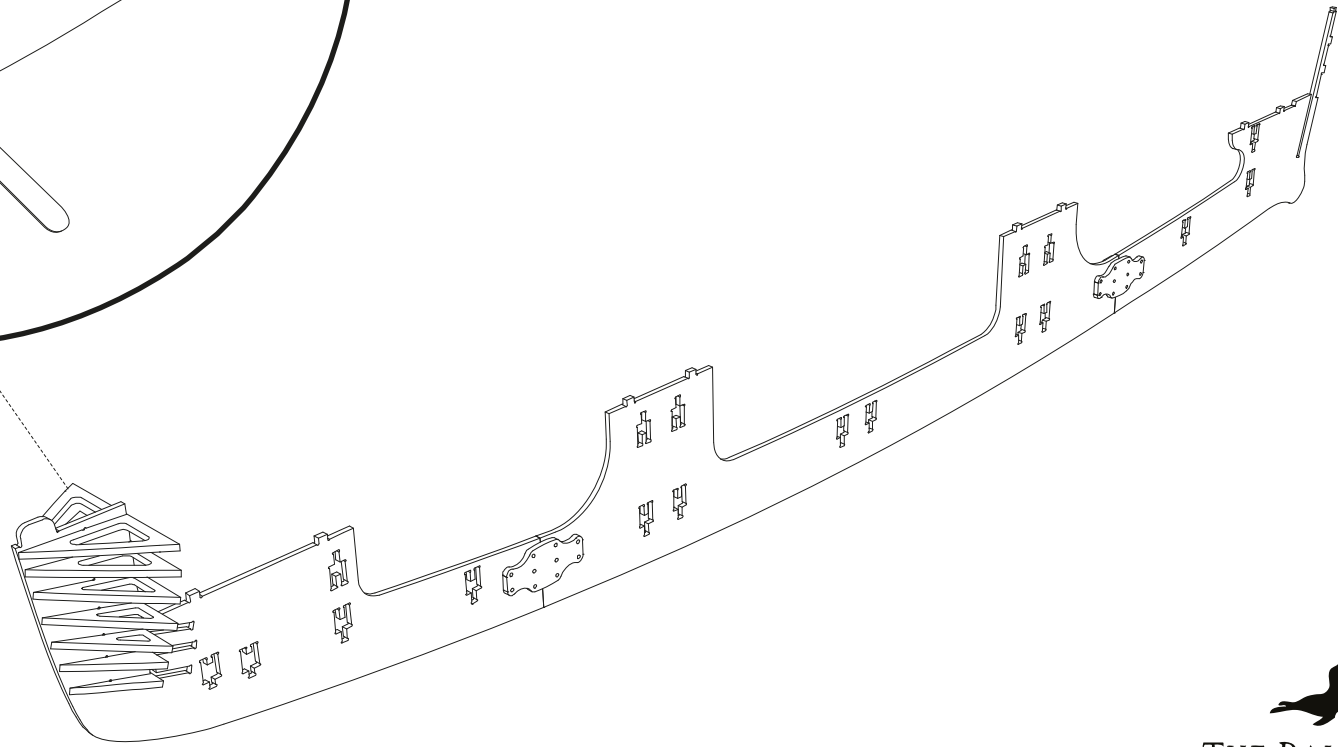
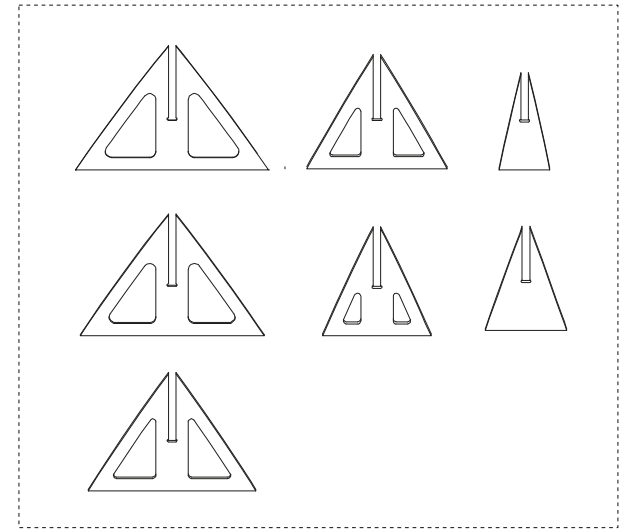
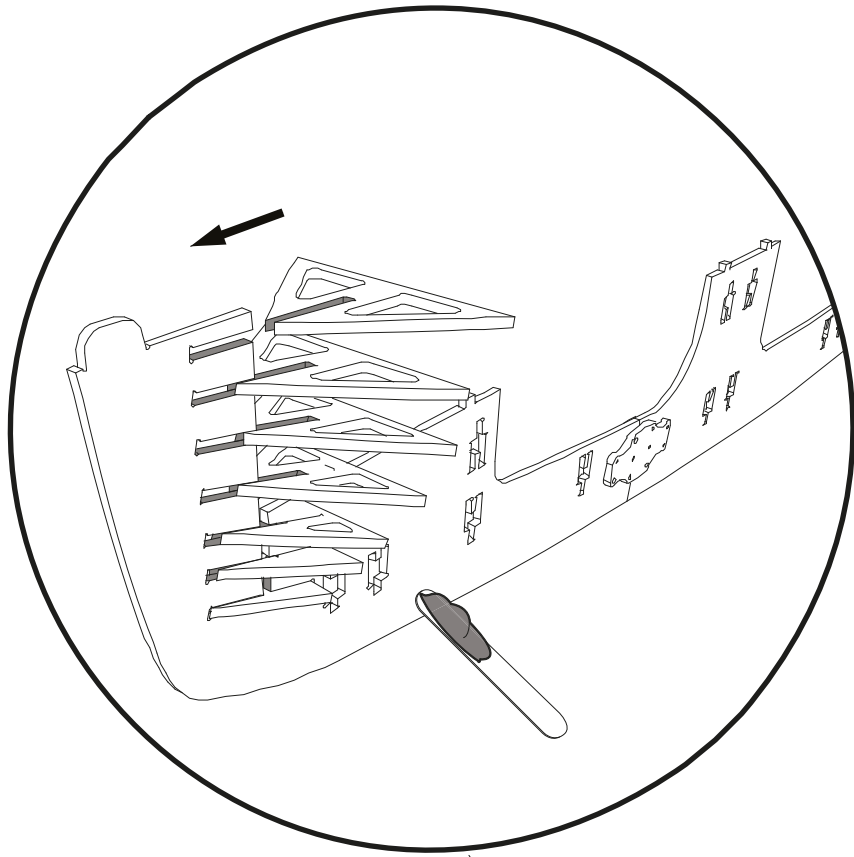

STEP 5

1.

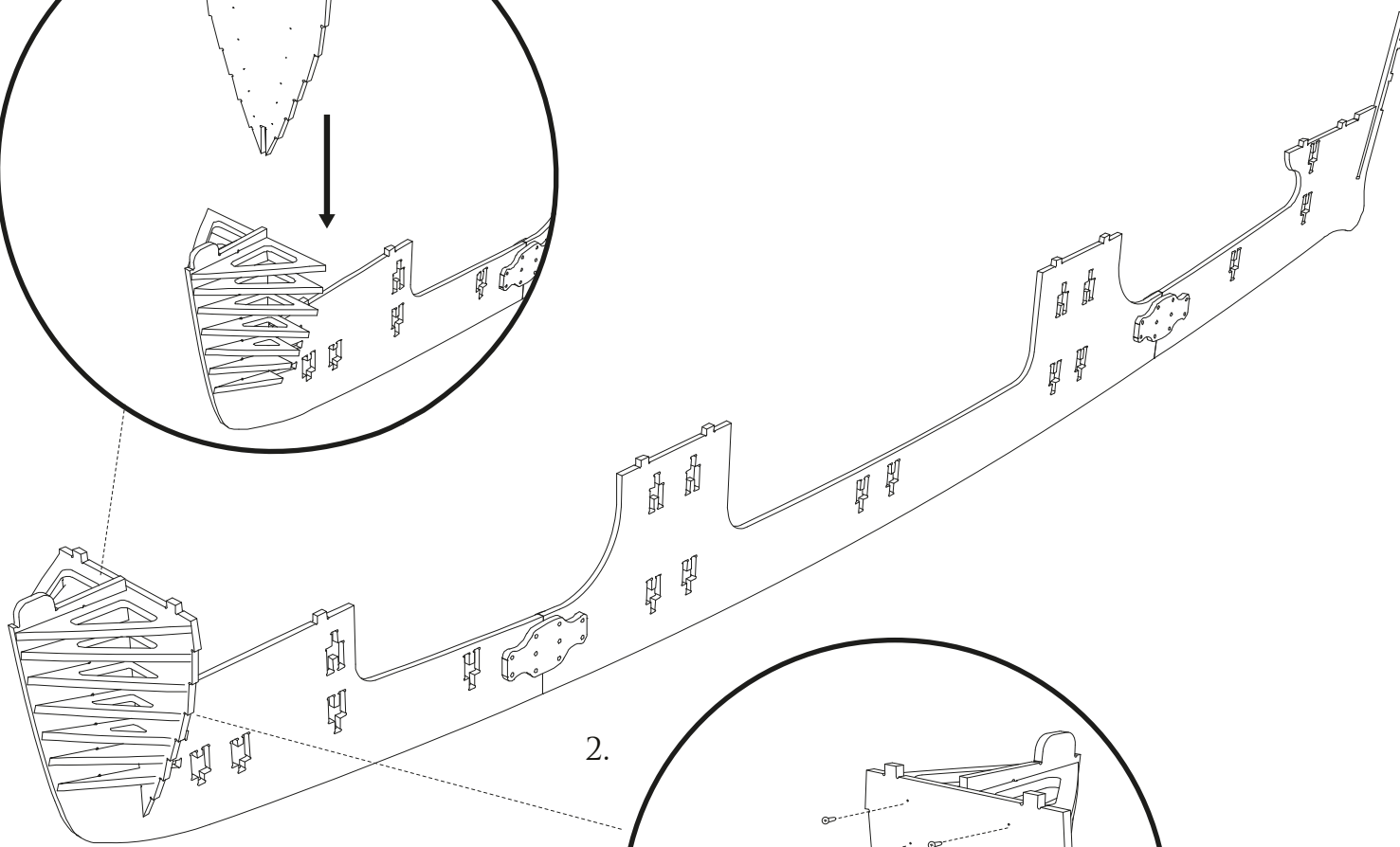
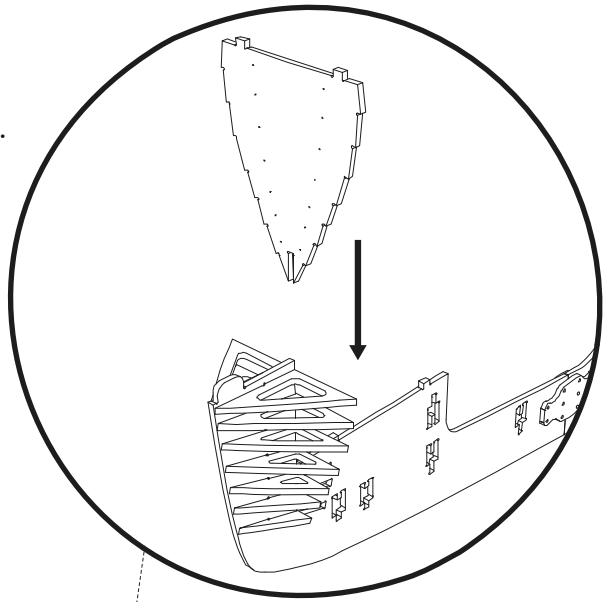

2.

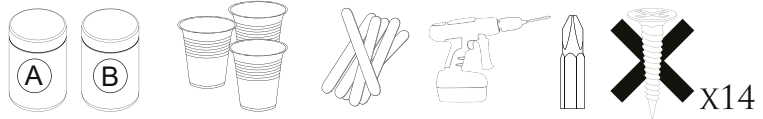
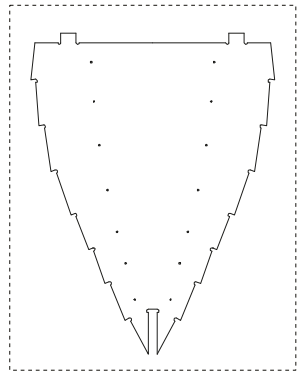
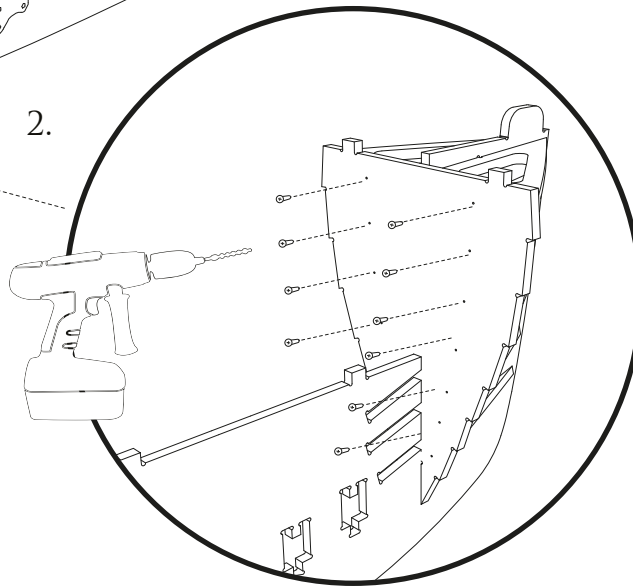

STEP 6

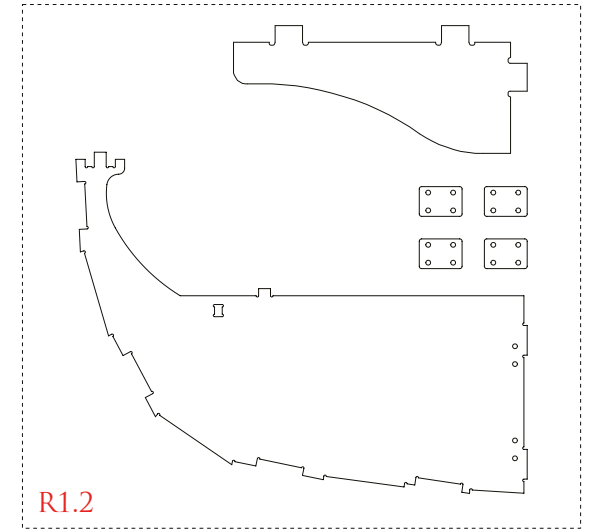
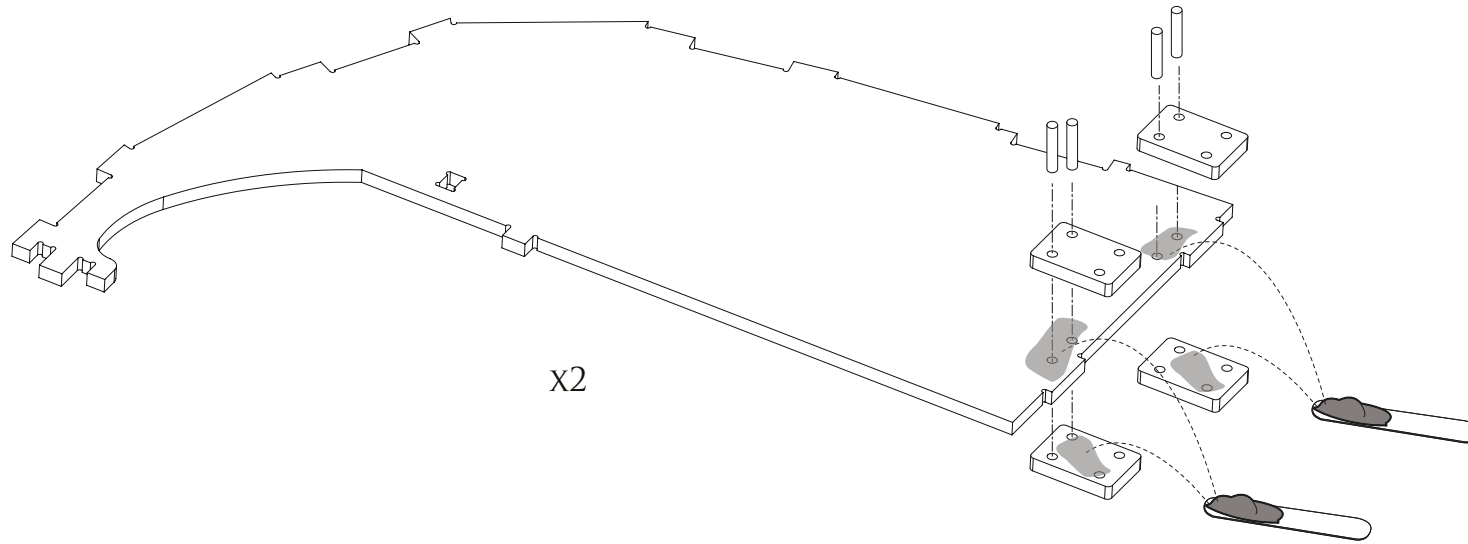

STEP 7

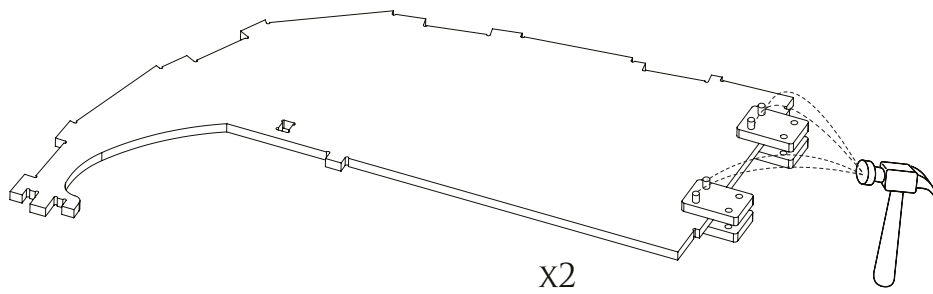

STEP 8

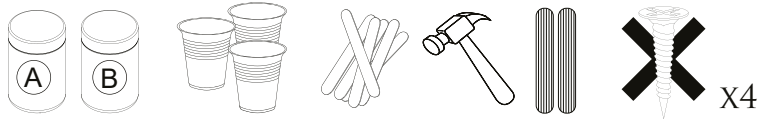
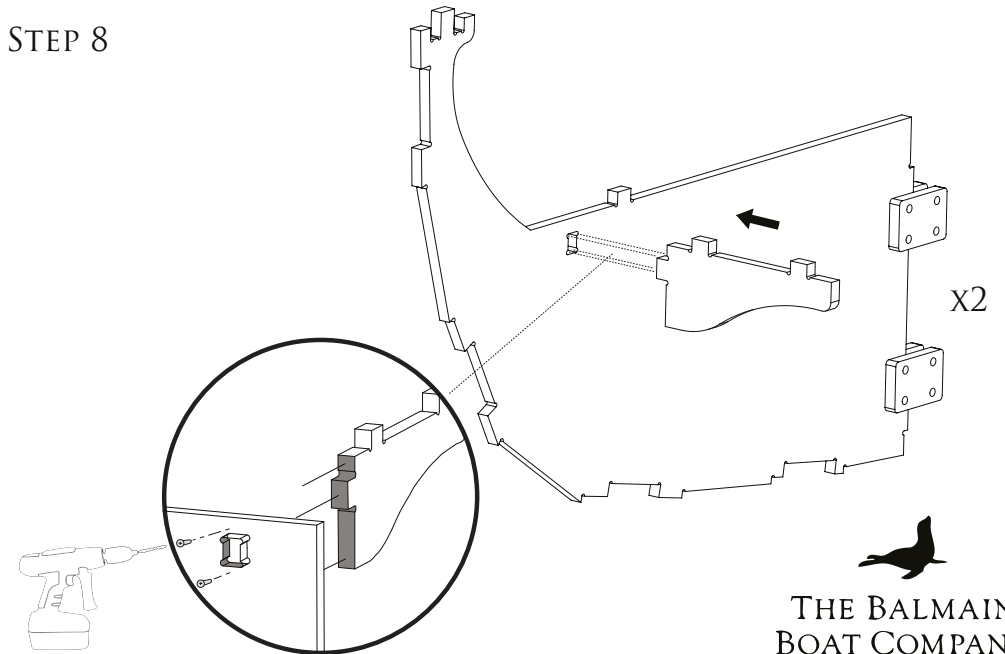

STEP 9

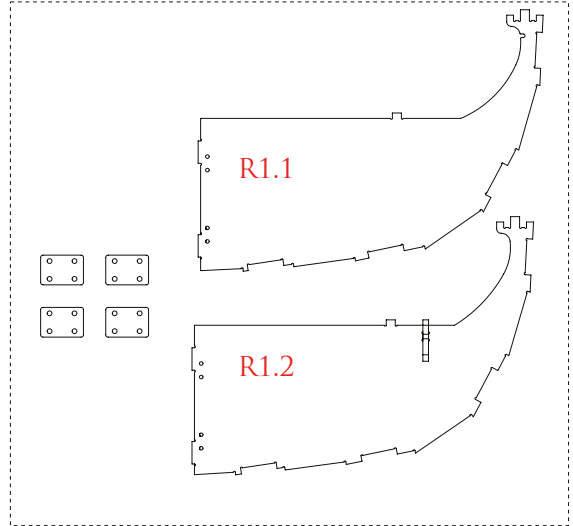
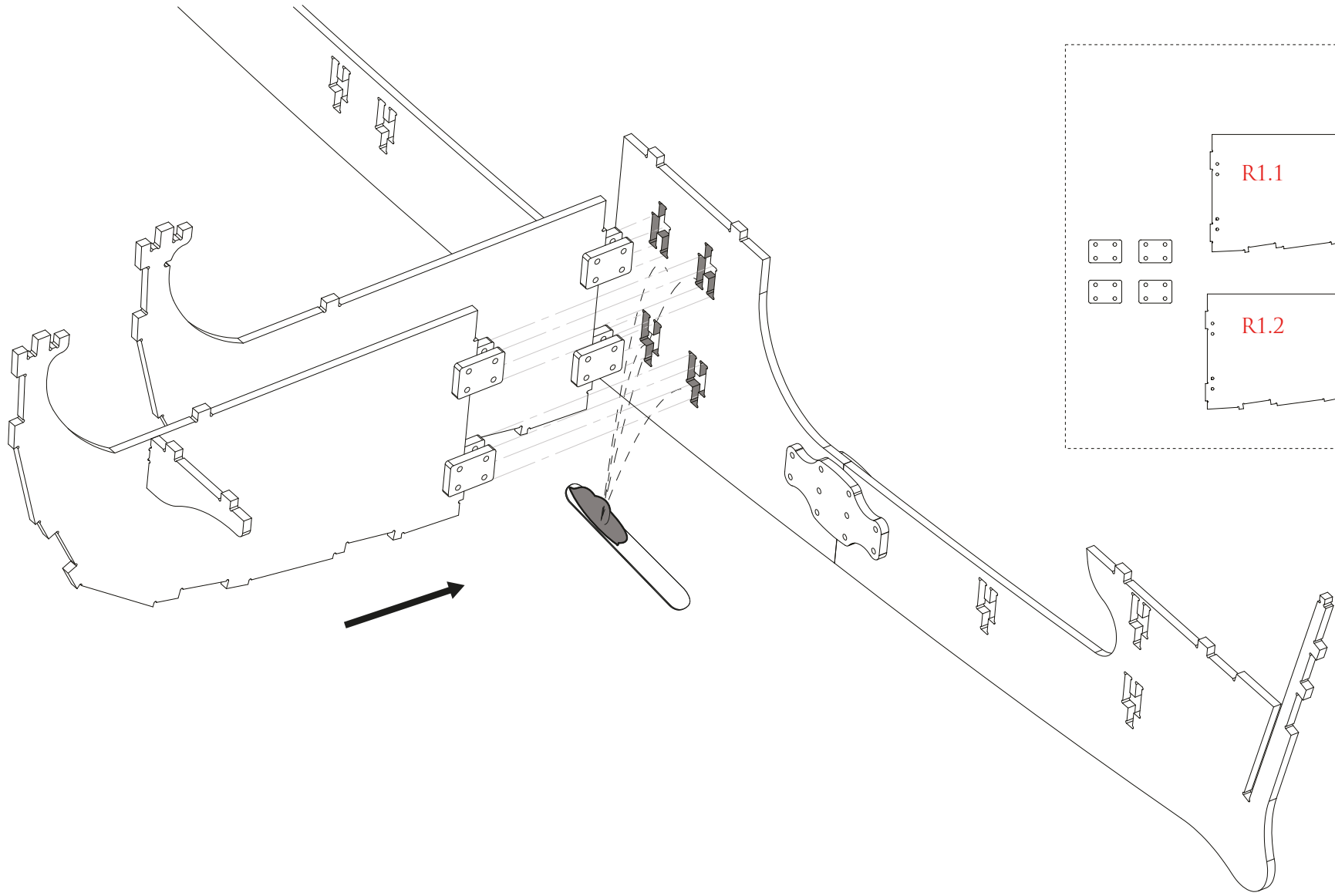



STEP 10

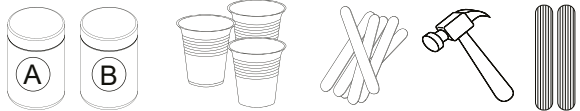
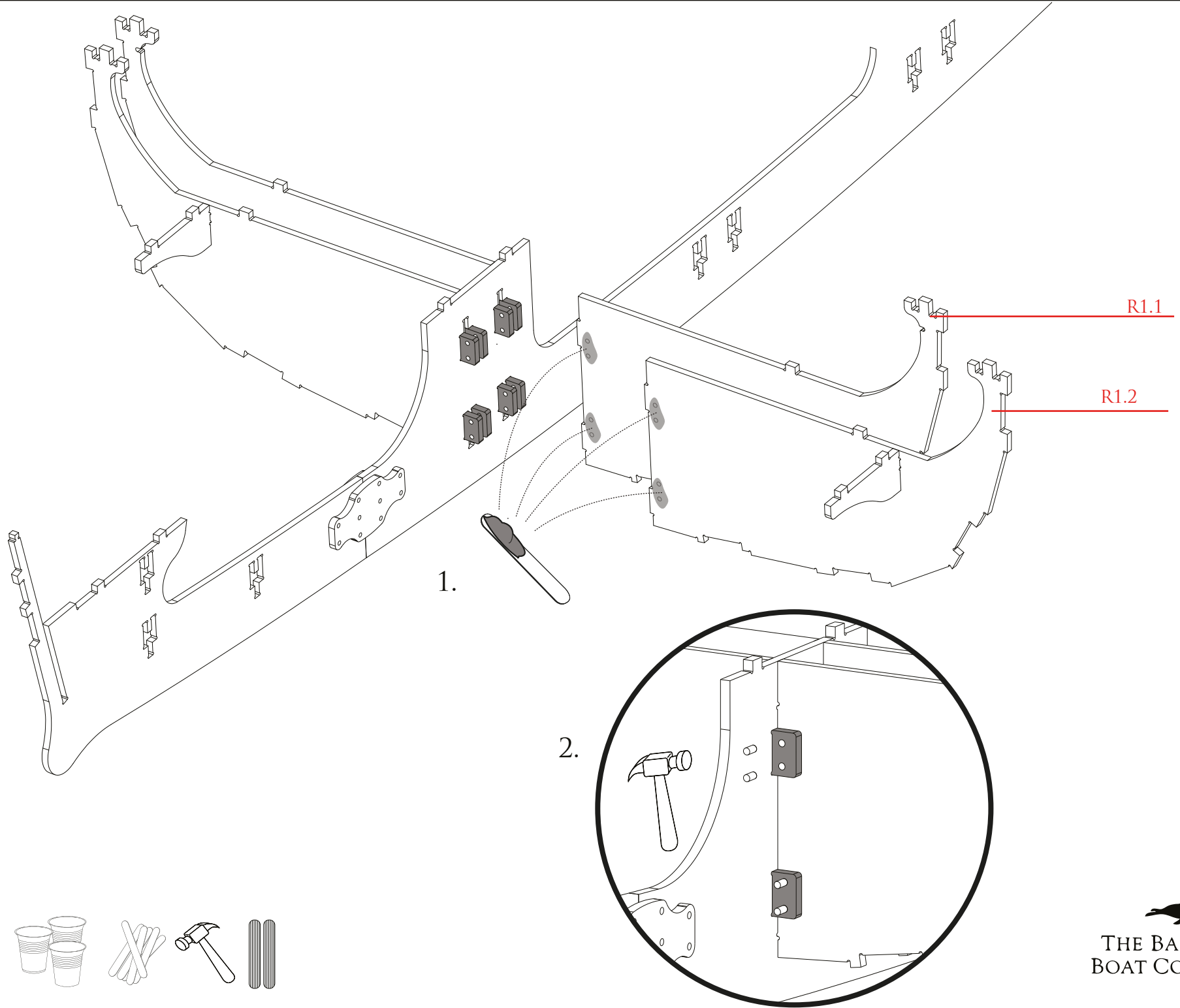

# STEP 11

REPEAT STEPS 6 AND 7 FOR EACH RIB

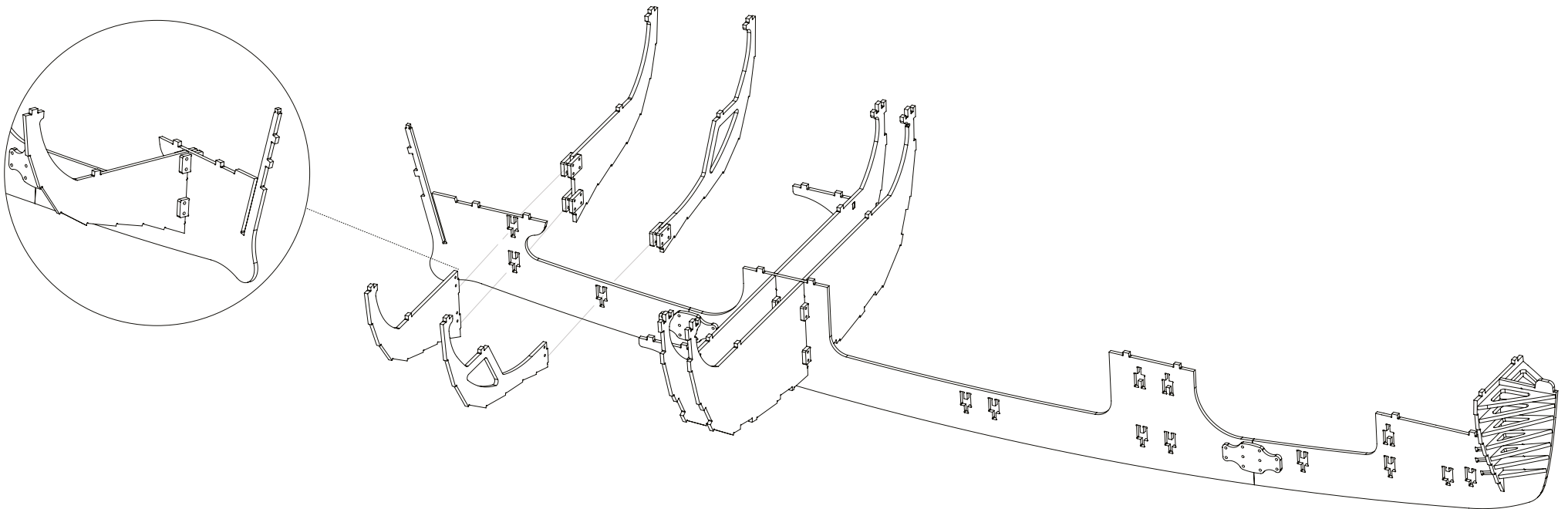
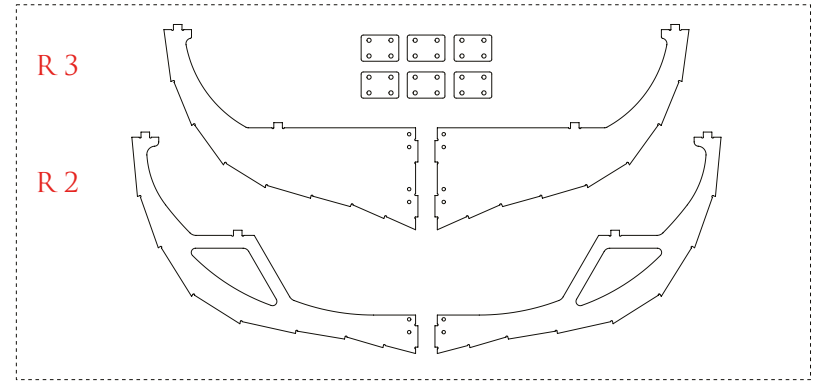
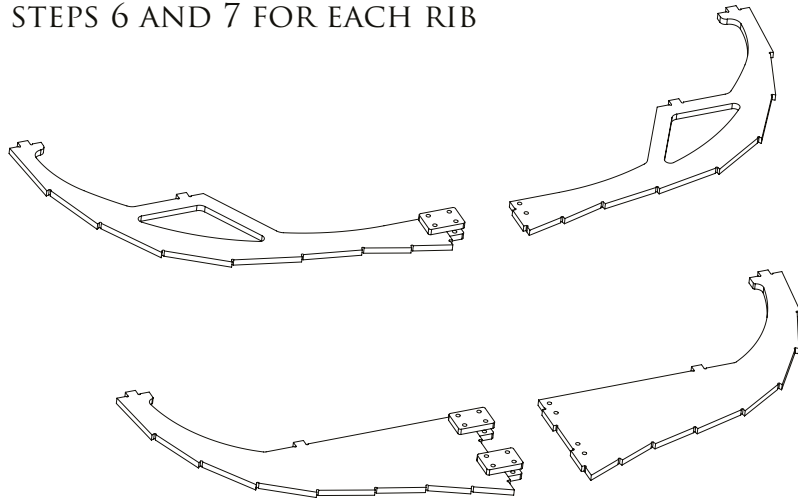

THE BALMAIN  
BOAT COMPANY

STEP 12

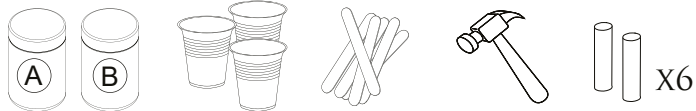
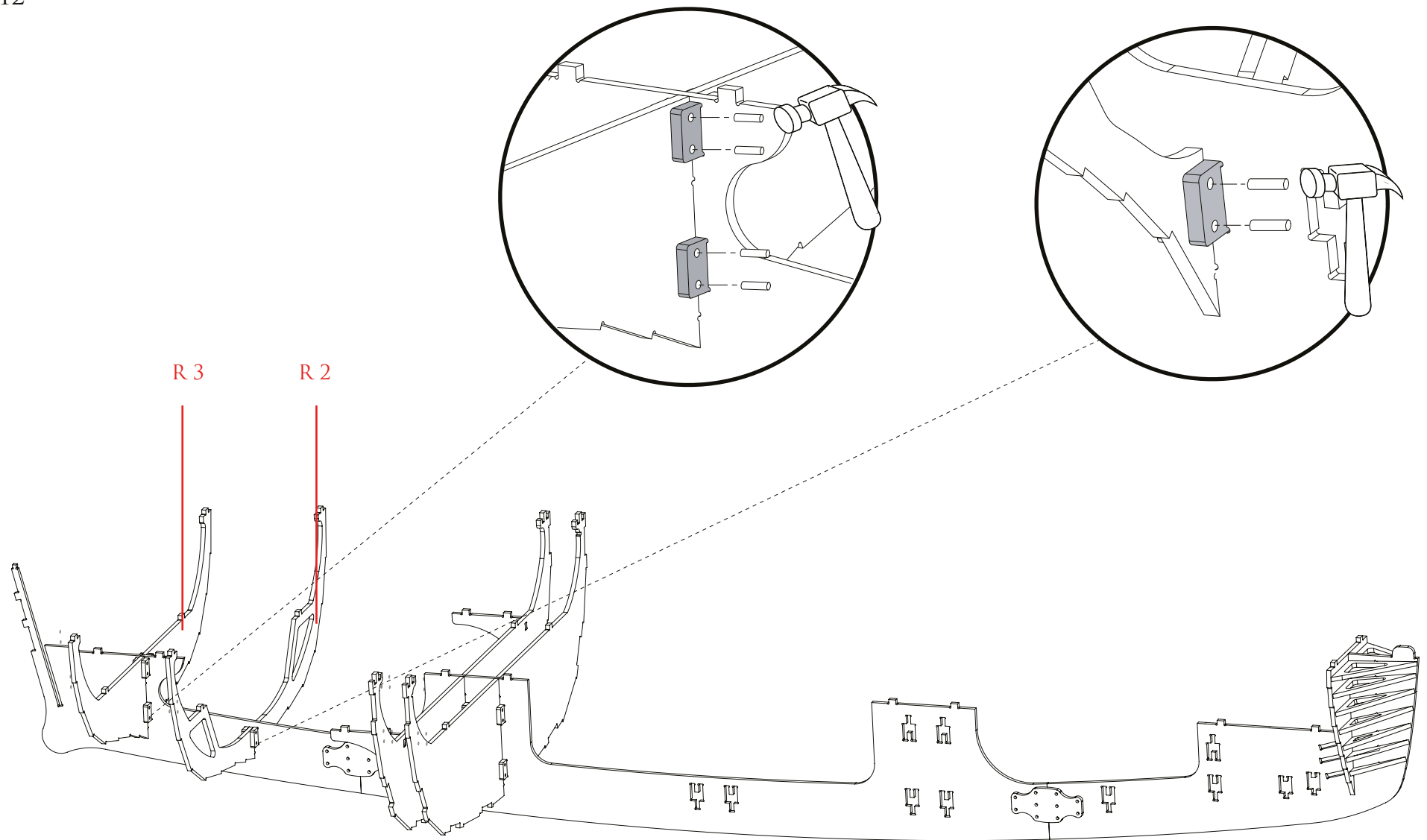

THE BALMAIN  
BOAT COMPANY

# STEP 13

## ORGANISE REMAINING RIBS

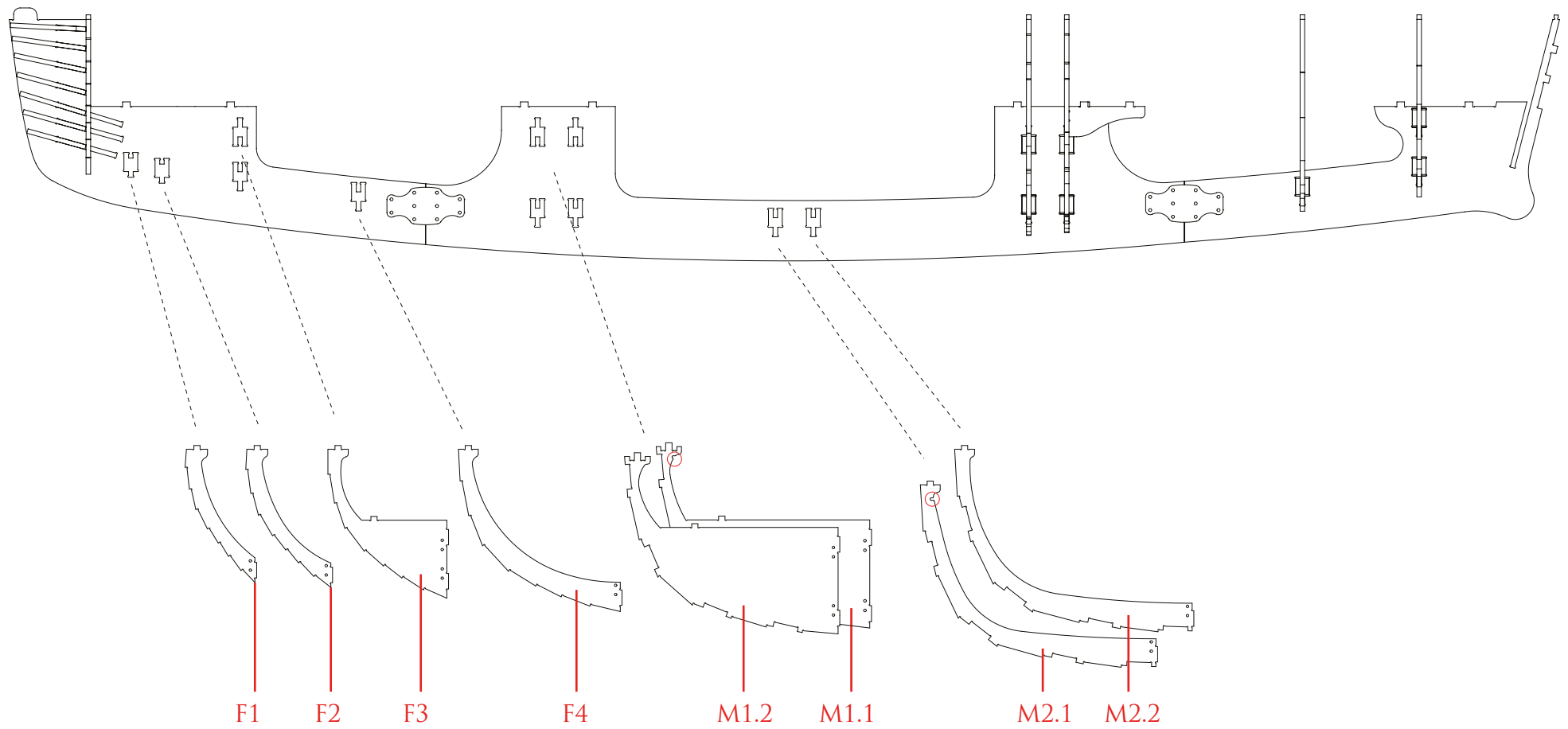

# STEP 14

REPEAT STEPS 6 AND 7 FOR EACH RIB

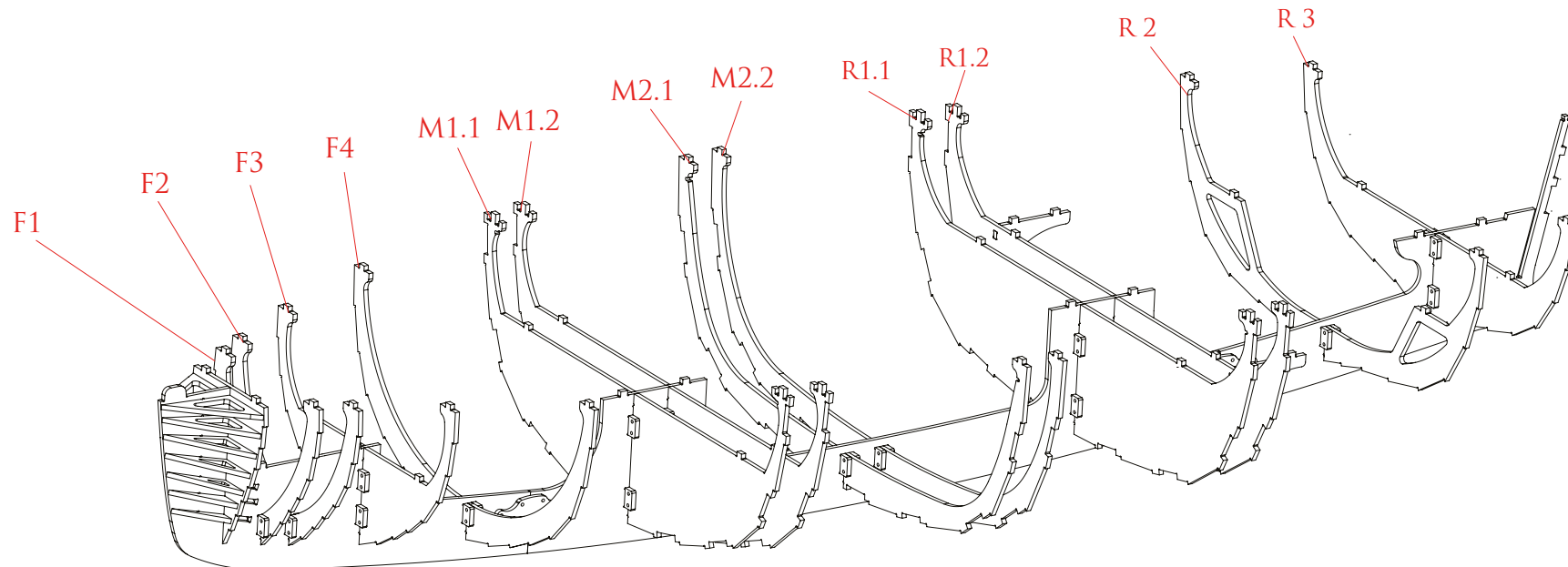
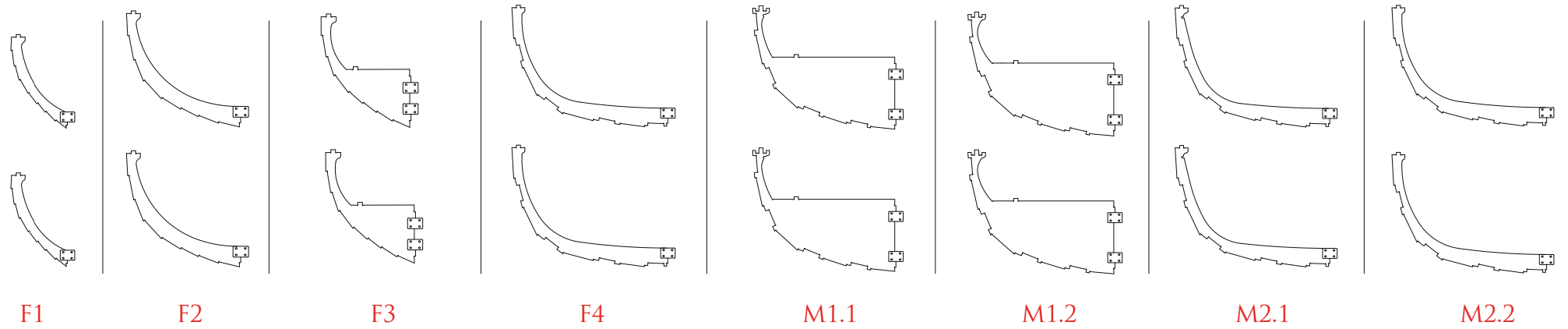

THE BALMAIN  
BOAT COMPANY

STEP 15

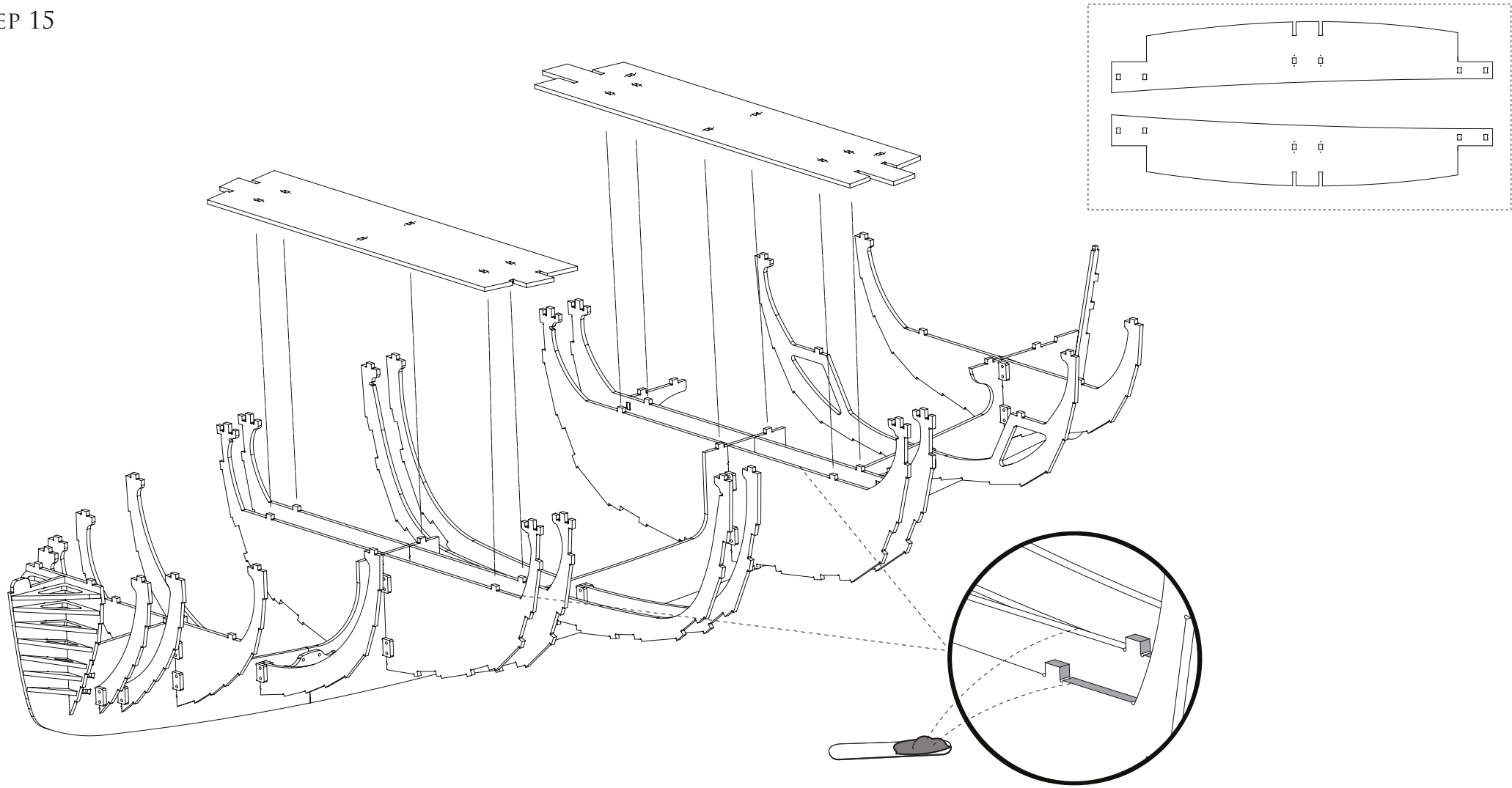

APPLY GLUE TO ALL JOINS



STEP 16

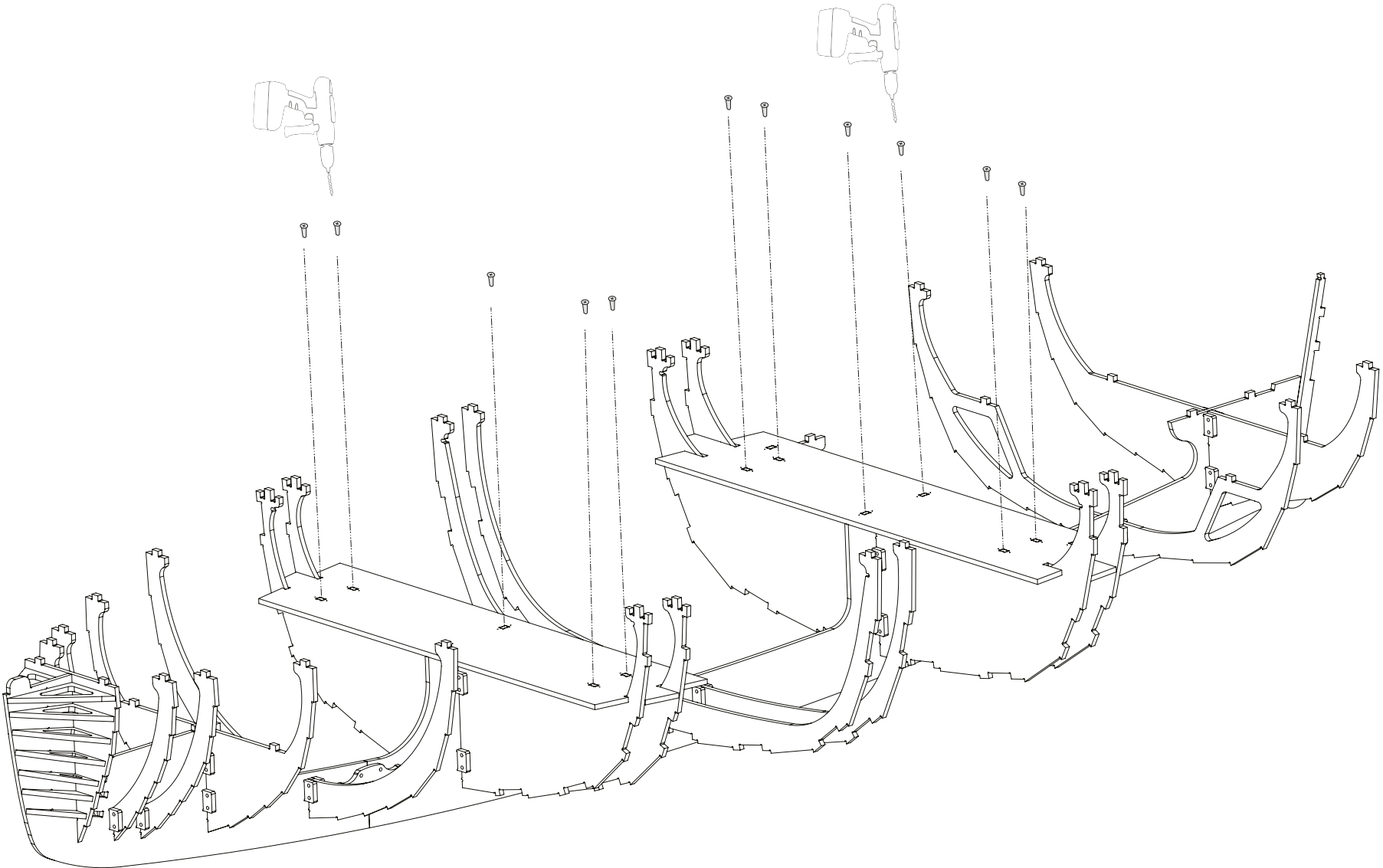

x11

STEP 17

1.

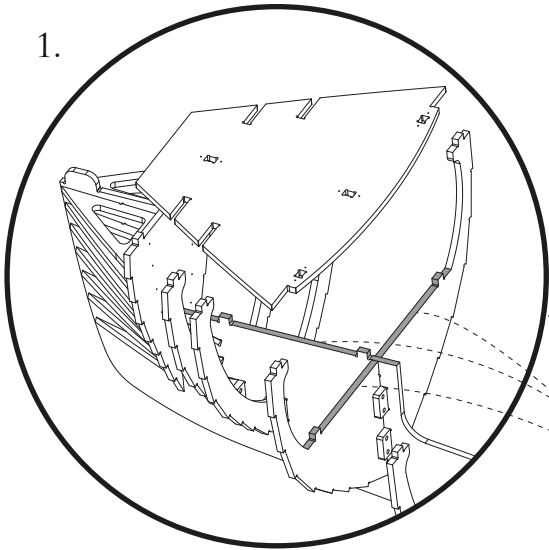

APPLY GLUE TO ALL JOINS

2.

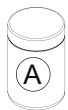
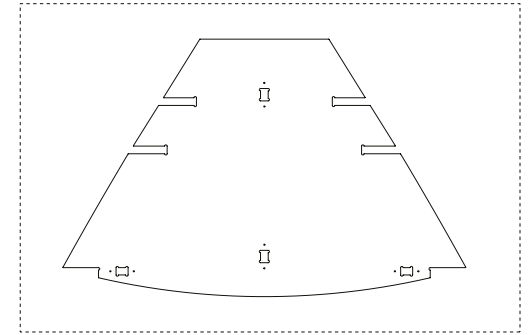
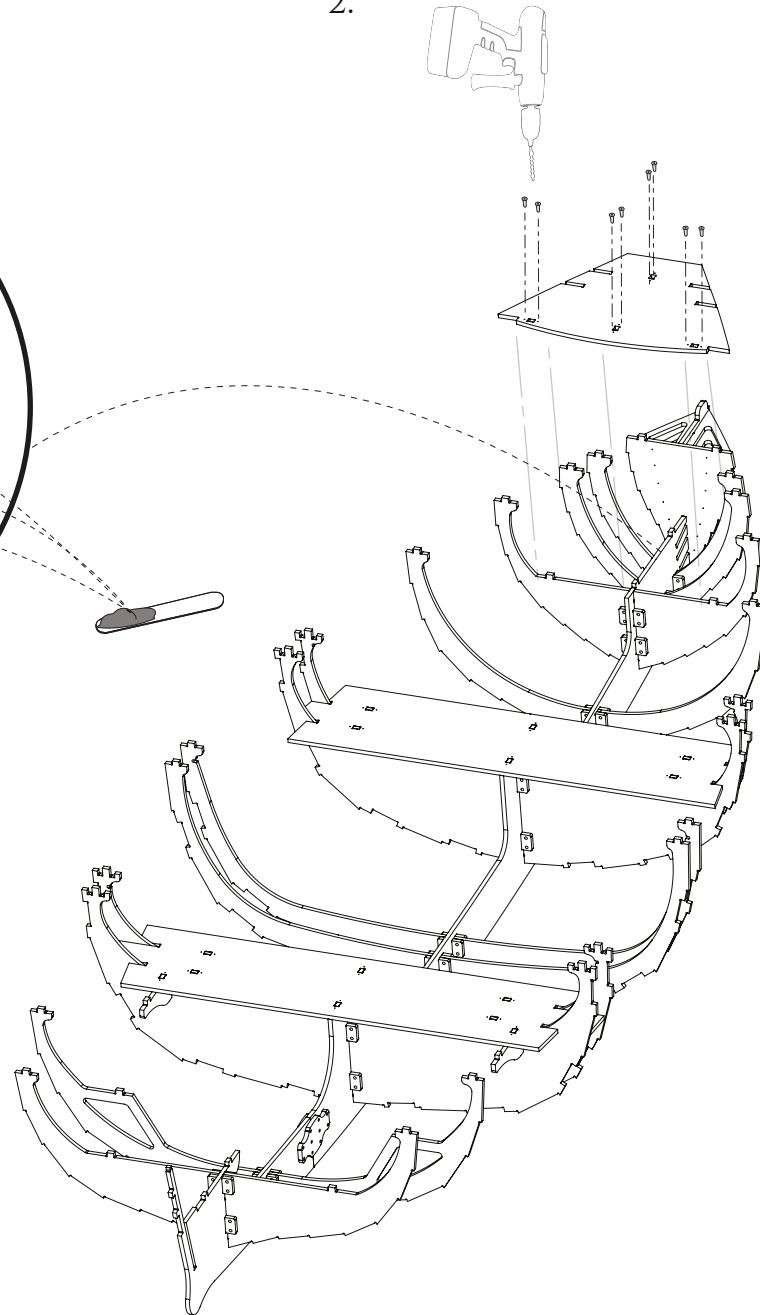

X8



THE BALMAIN  
BOAT COMPANY



STEP 18

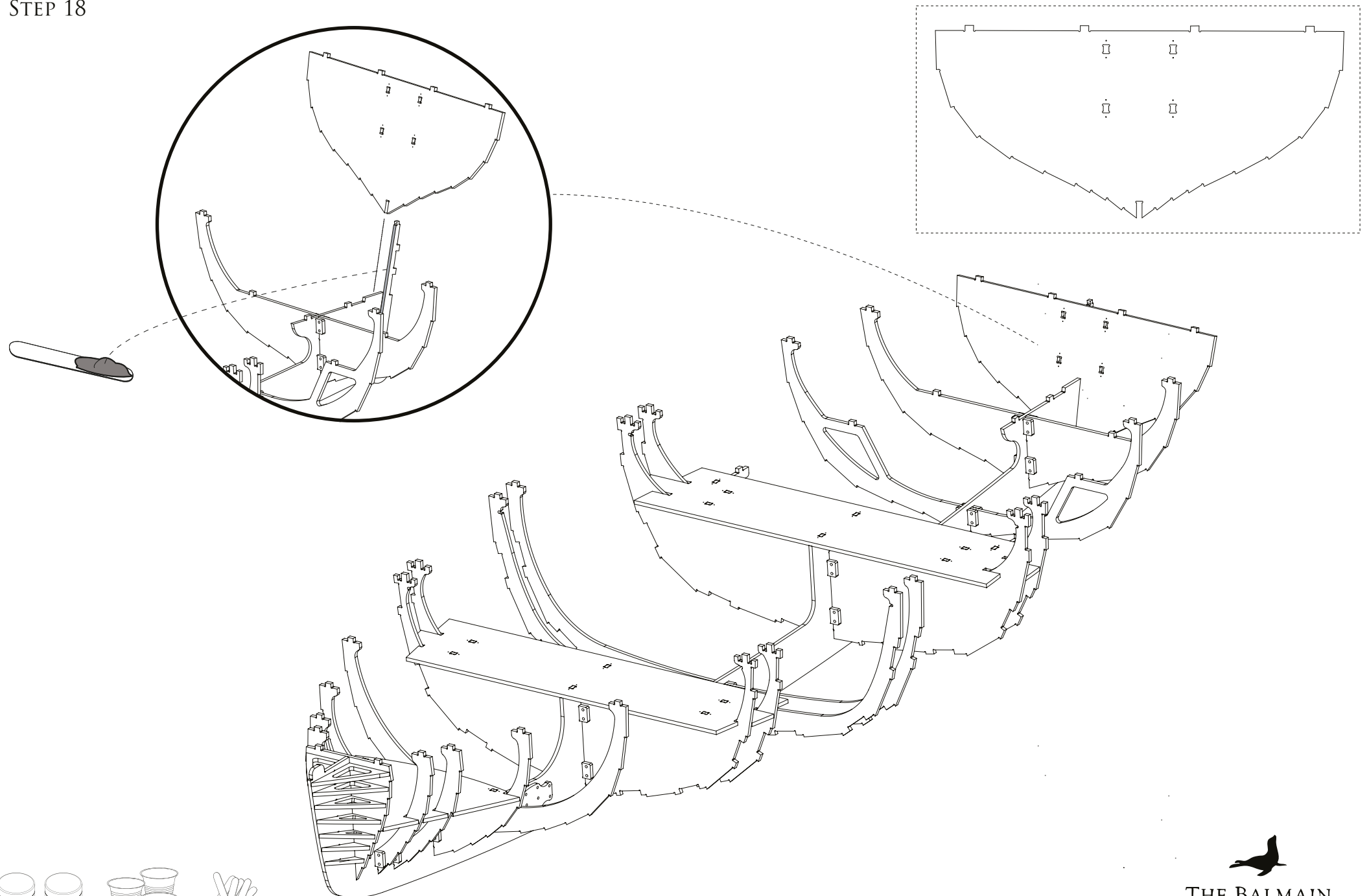

THE BALMAIN  
BOAT COMPANY

STEP 19

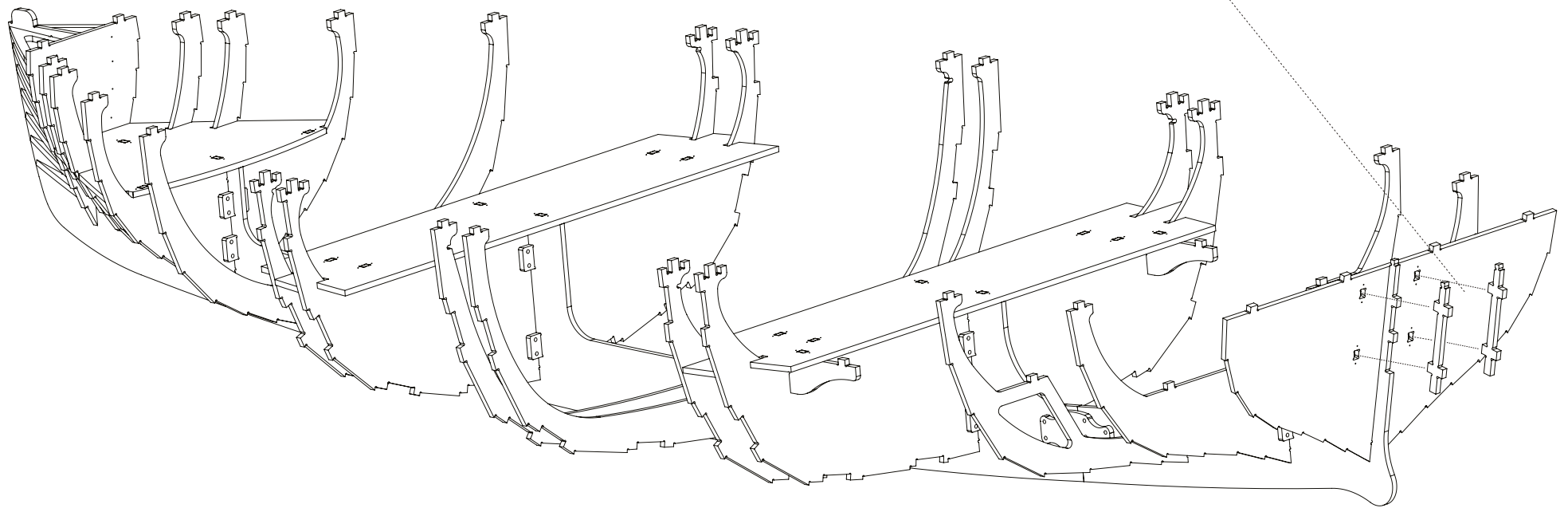
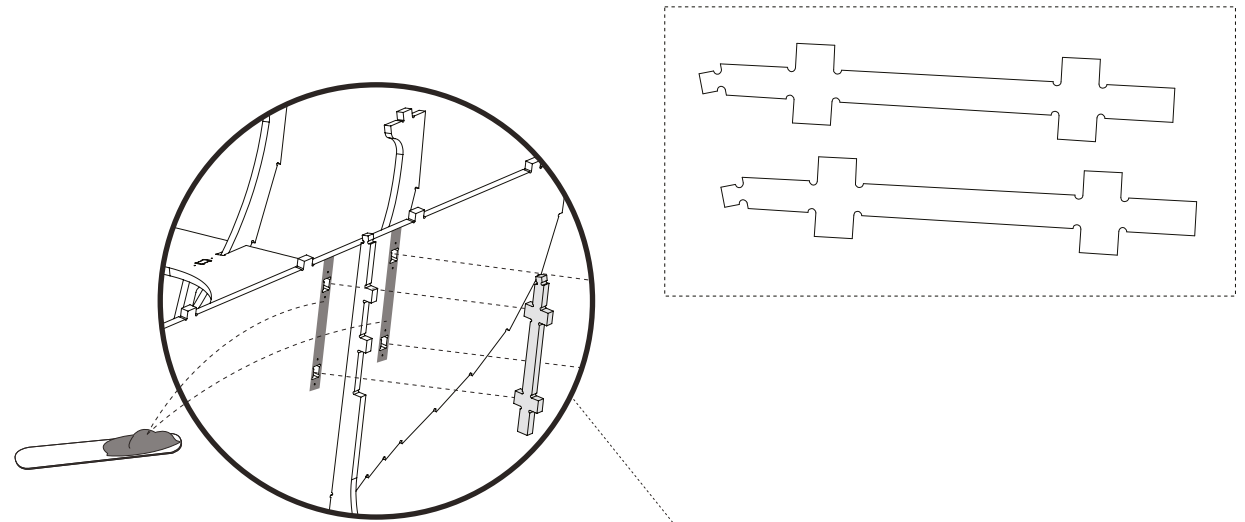

THE BALMAIN  
BOAT COMPANY

STEP 20

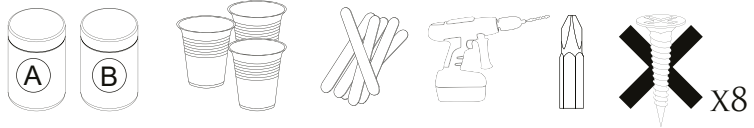
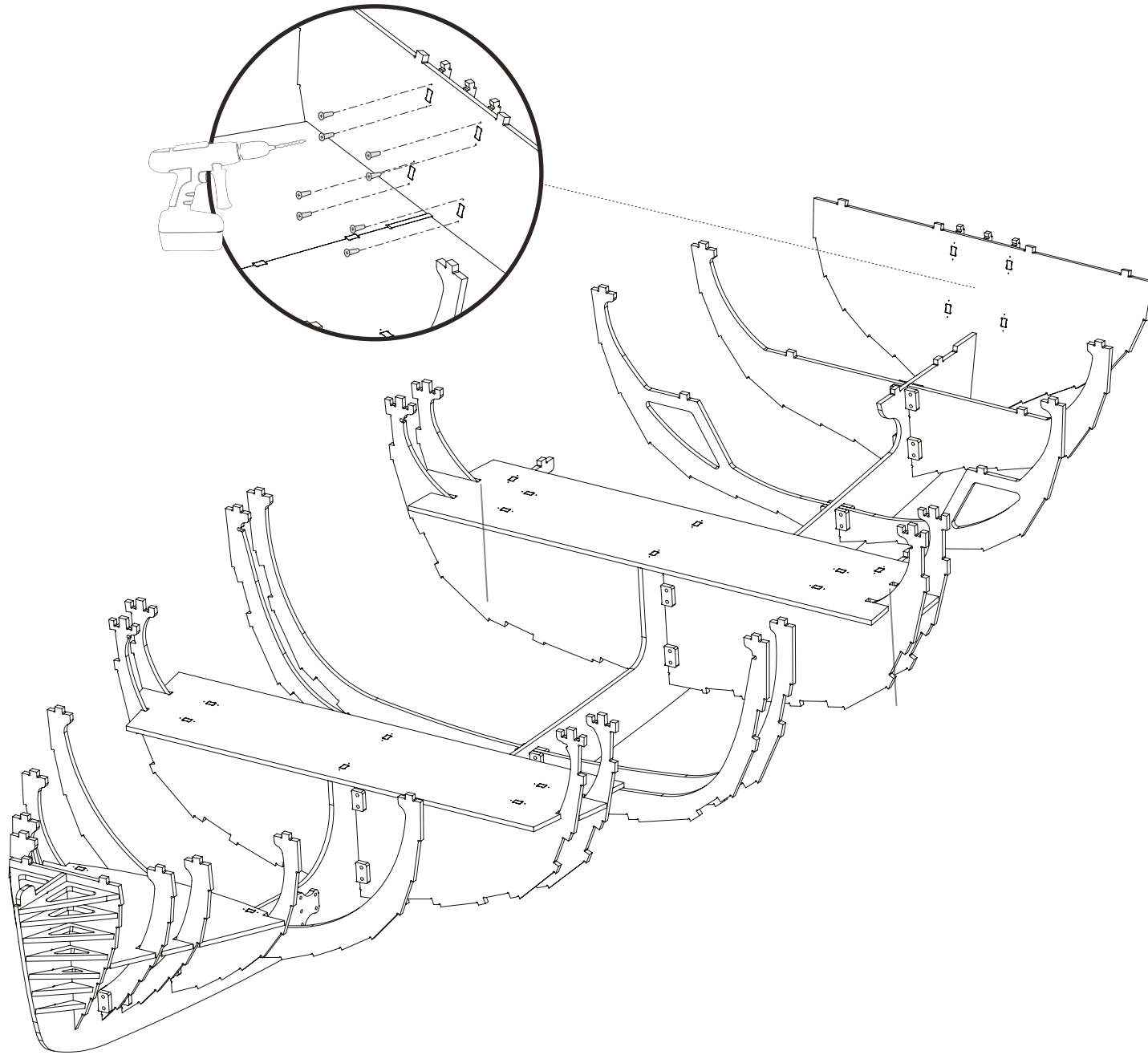

STEP 21

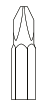
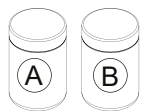
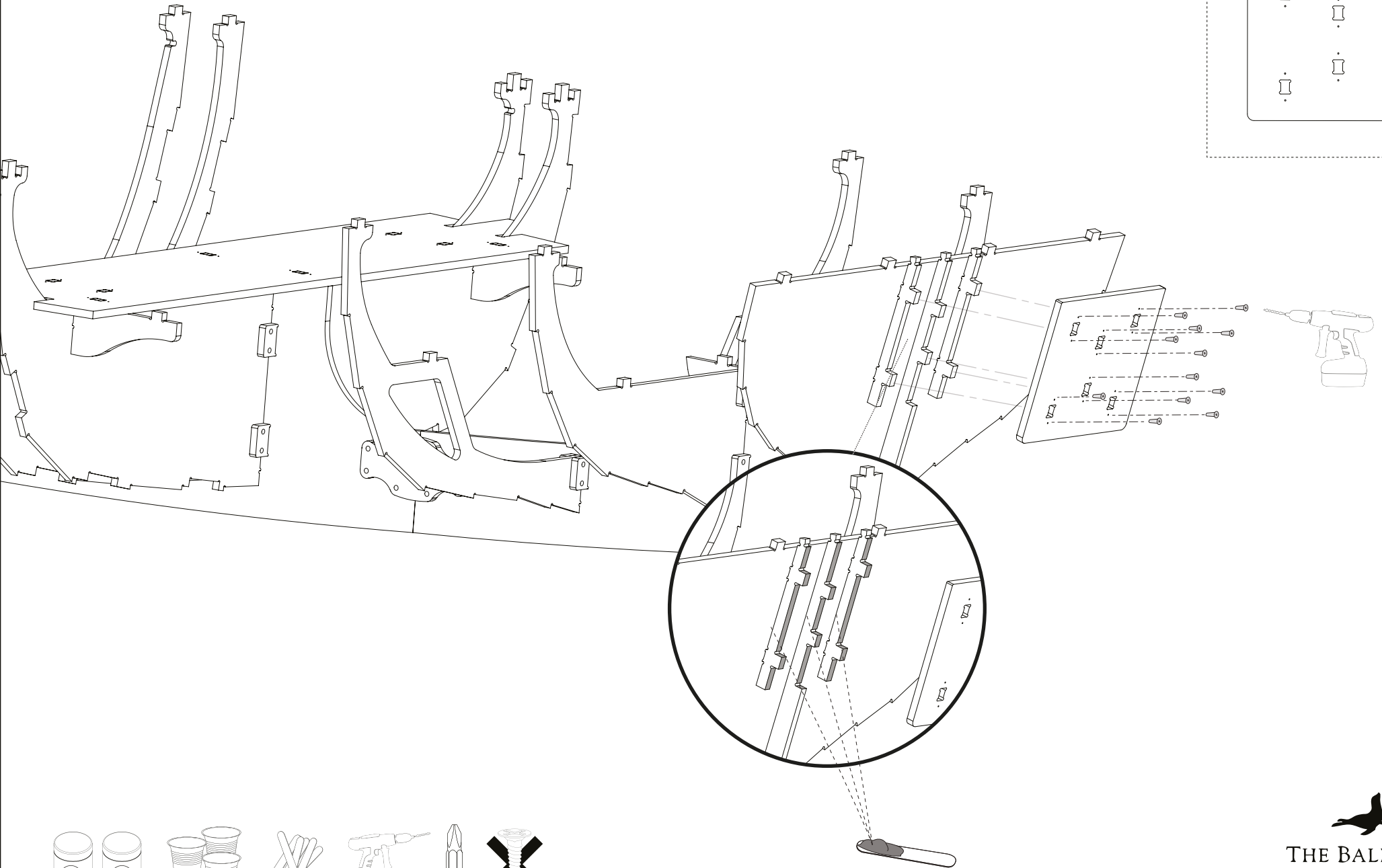

STEP 22

APPLY GLUE IN ALL JOINING AREAS

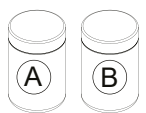
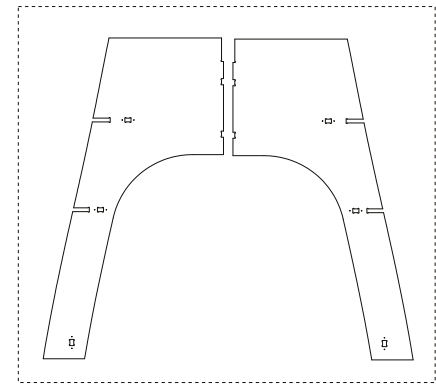
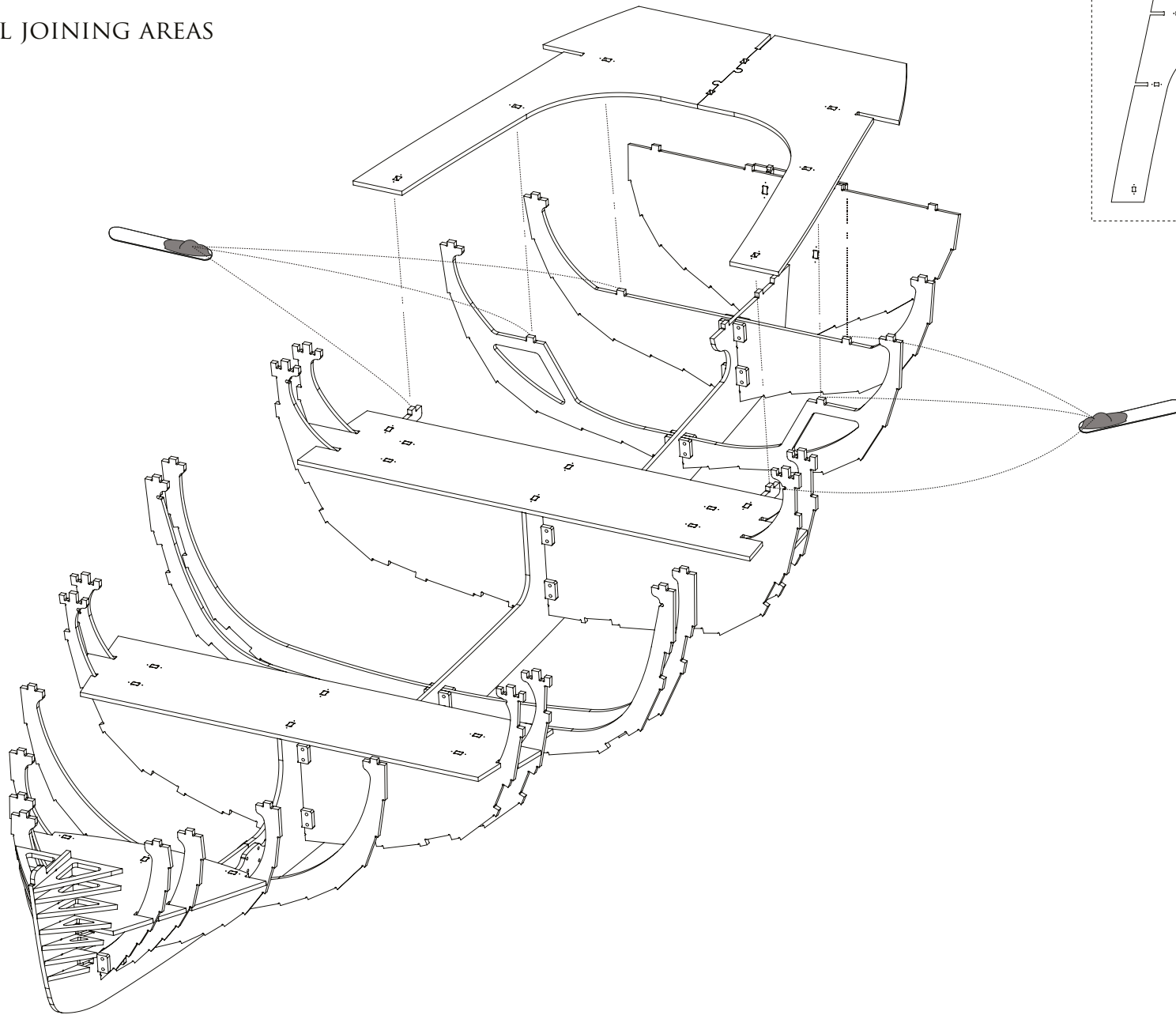

THE BALMAIN  
BOAT COMPANY

STEP 23

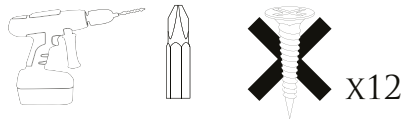
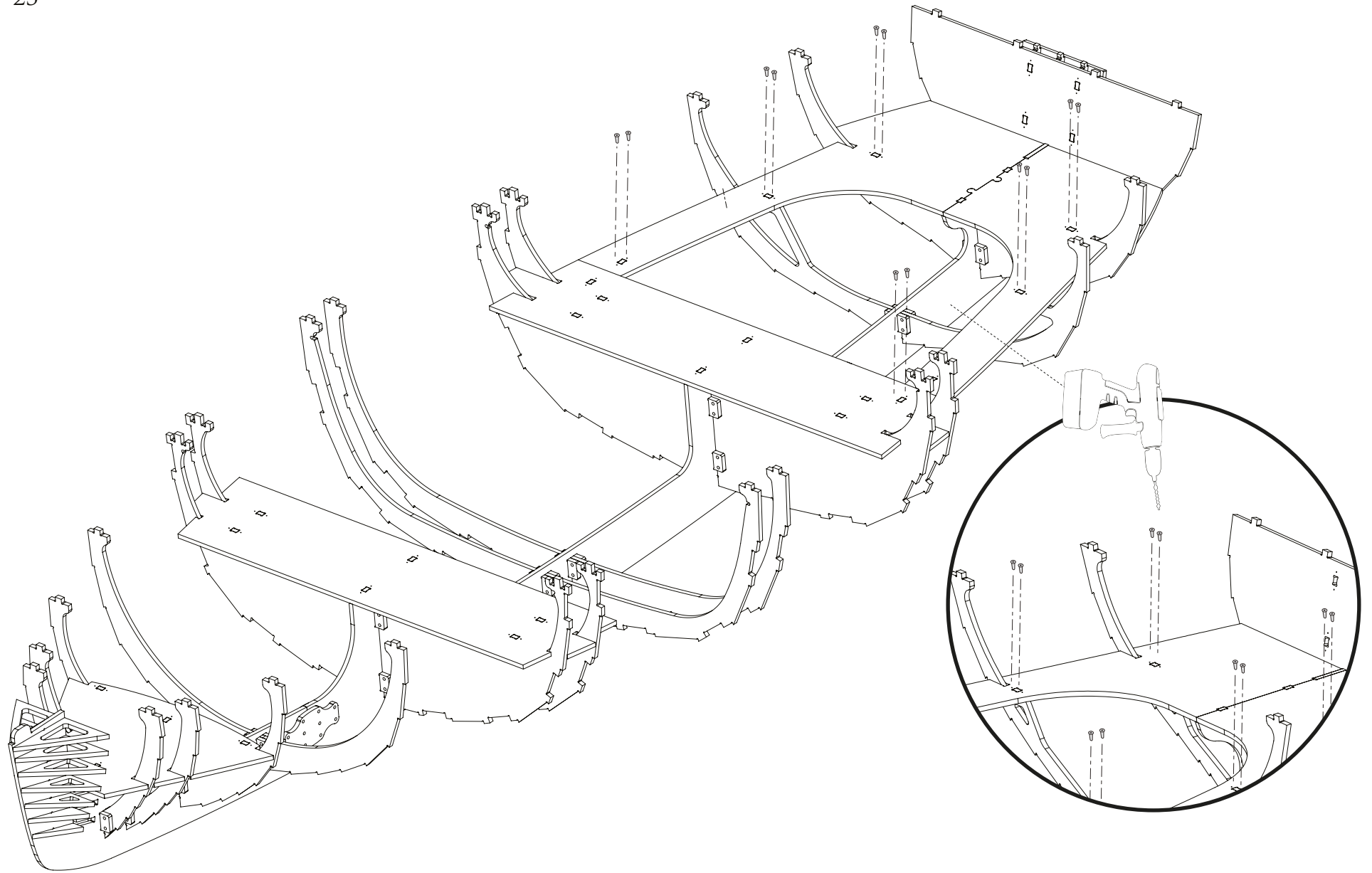

STEP 24

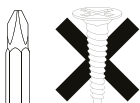
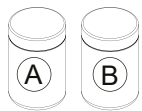
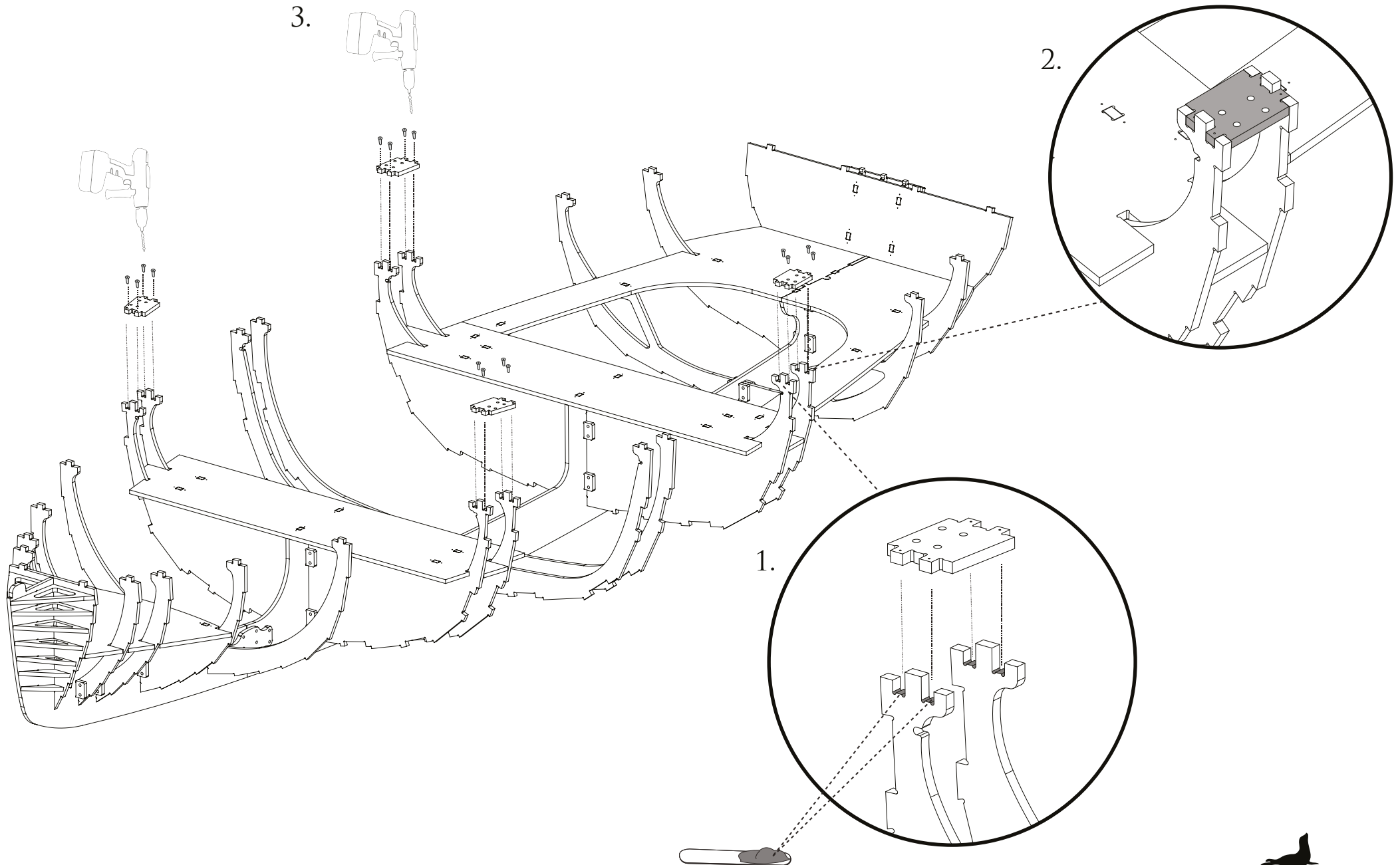

x16



THE BALMAIN  
BOAT COMPANY

STEP 25

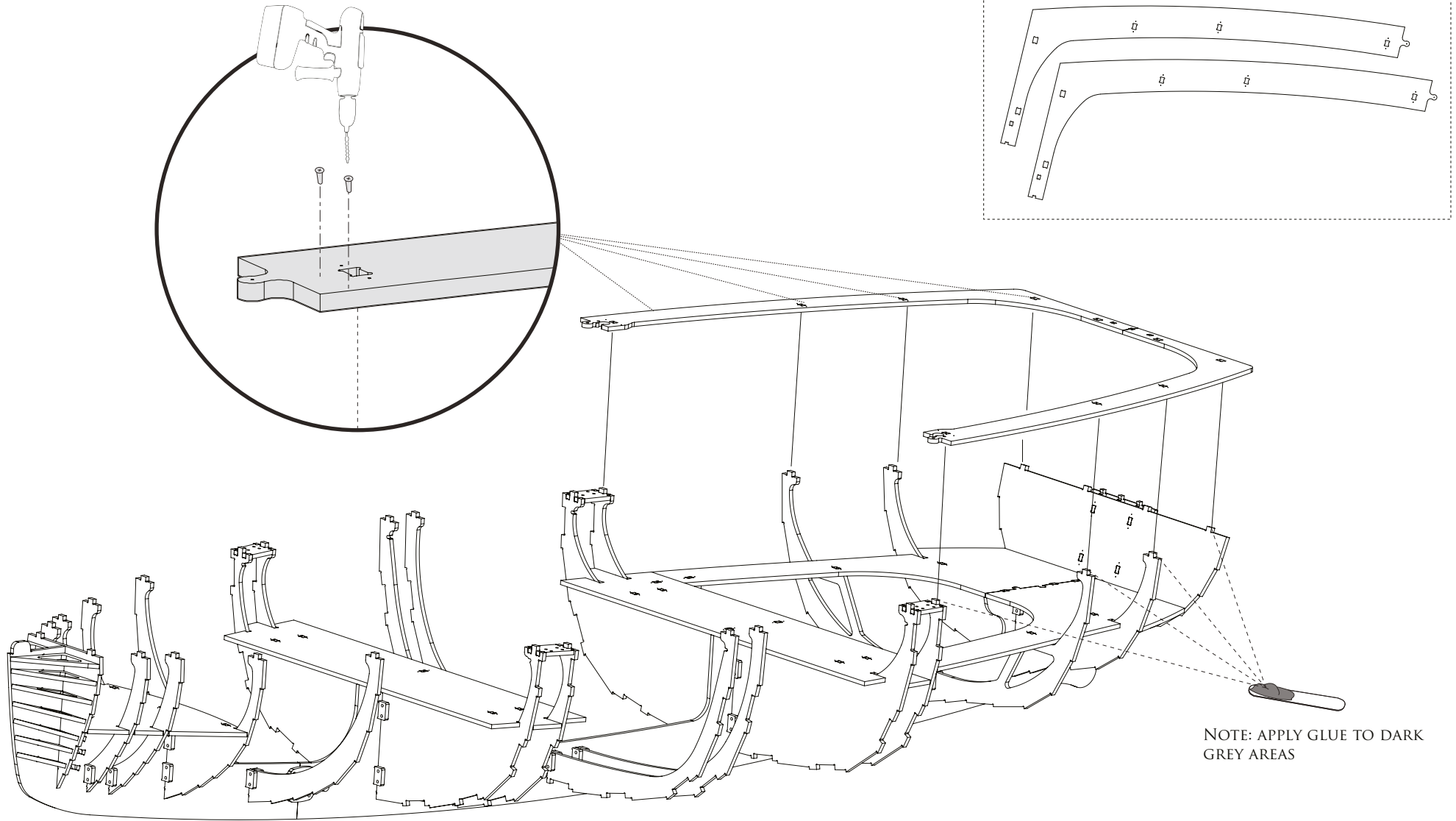

NOTE: APPLY GLUE TO DARK GREY AREAS

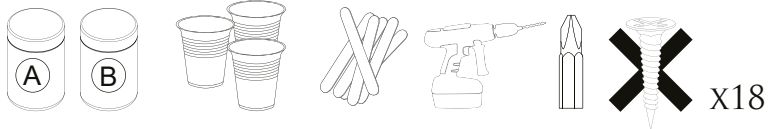



STEP 26

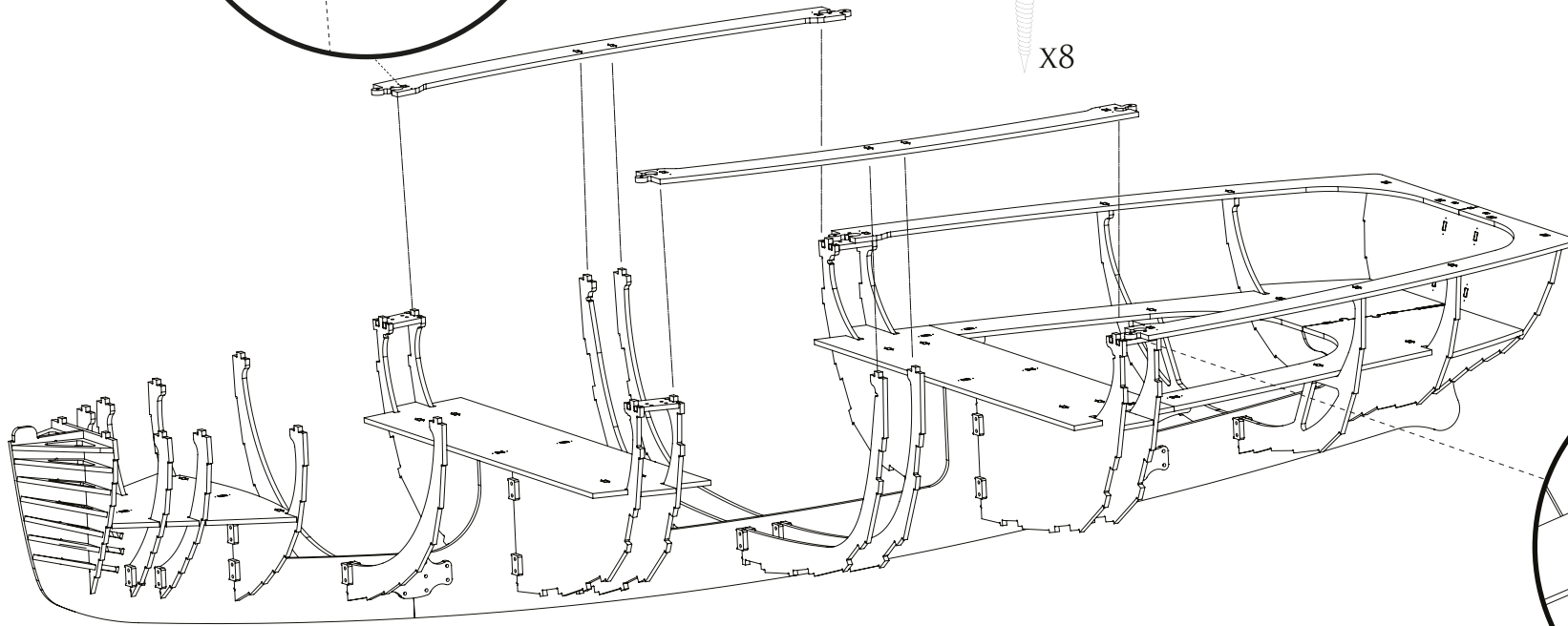
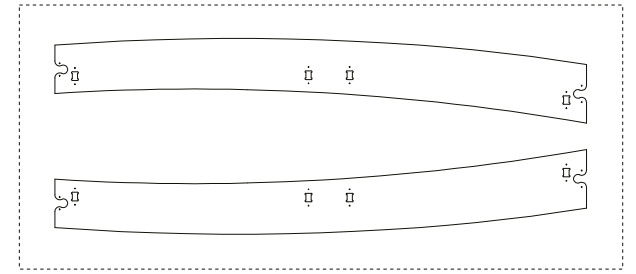
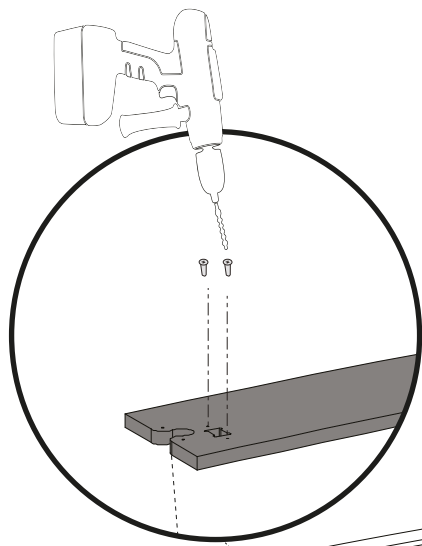

NOTE: APPLY GLUE TO ALL DARK GREY AREAS

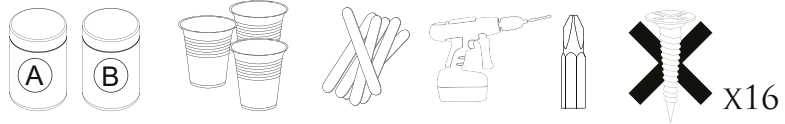
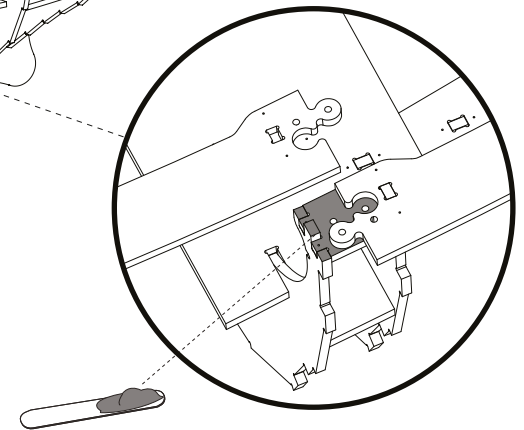

STEP 27

2.

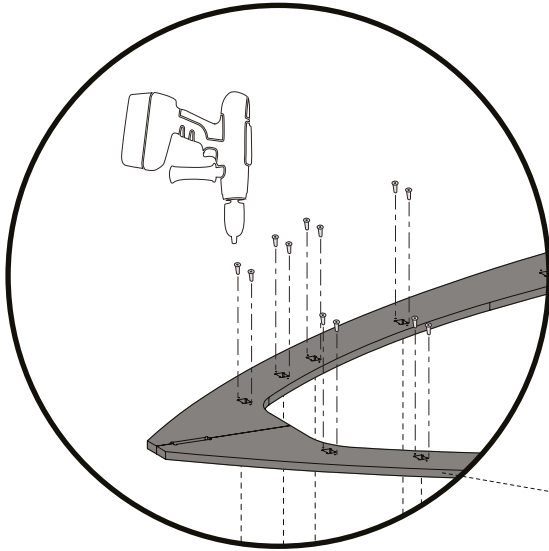

1.

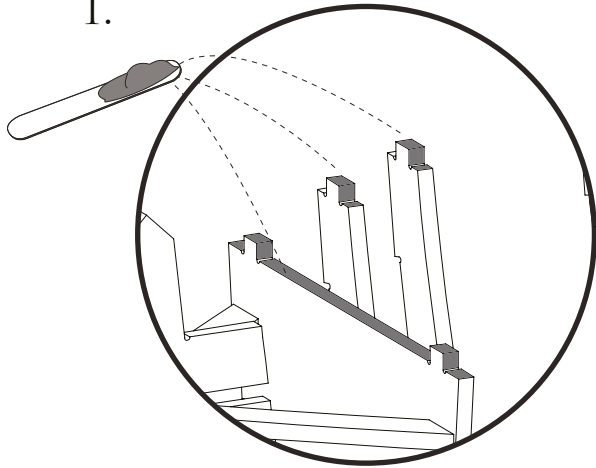

NOTE: APPLY GLUE TO ALL DARK GREY AREAS

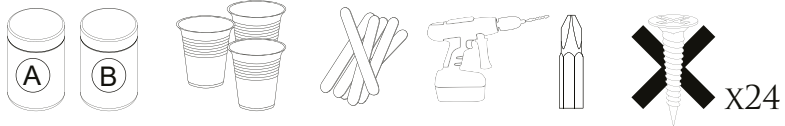
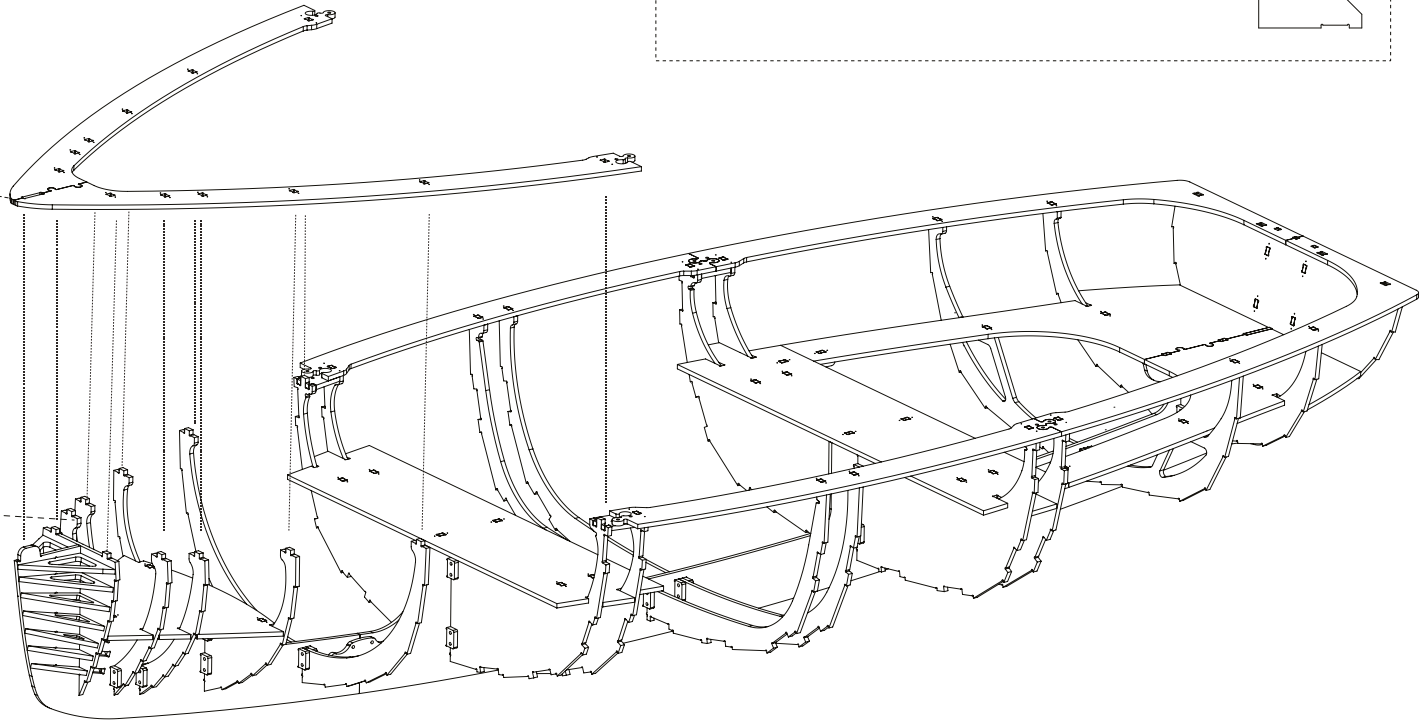
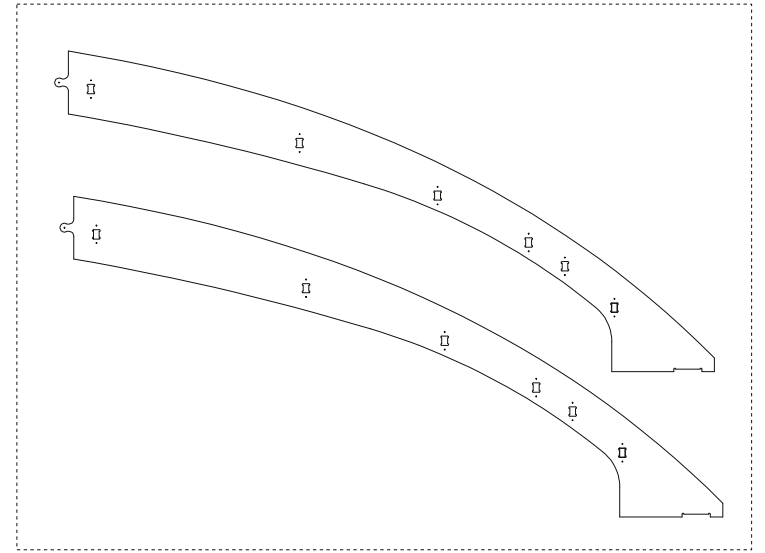

STEP 28

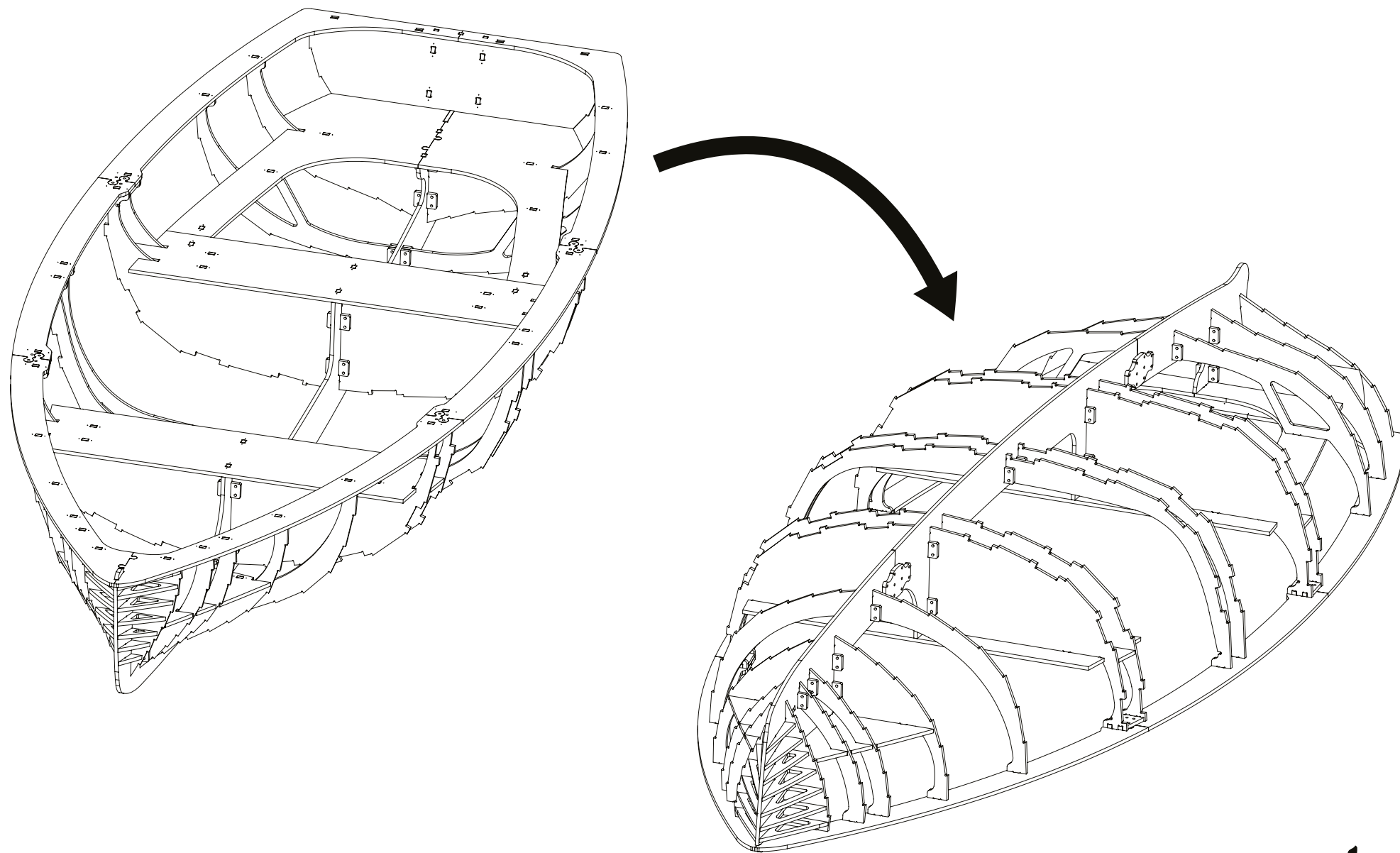

THE BALMAIN  
BOAT COMPANY

STEP 29  
PLACE ON BLOCKS

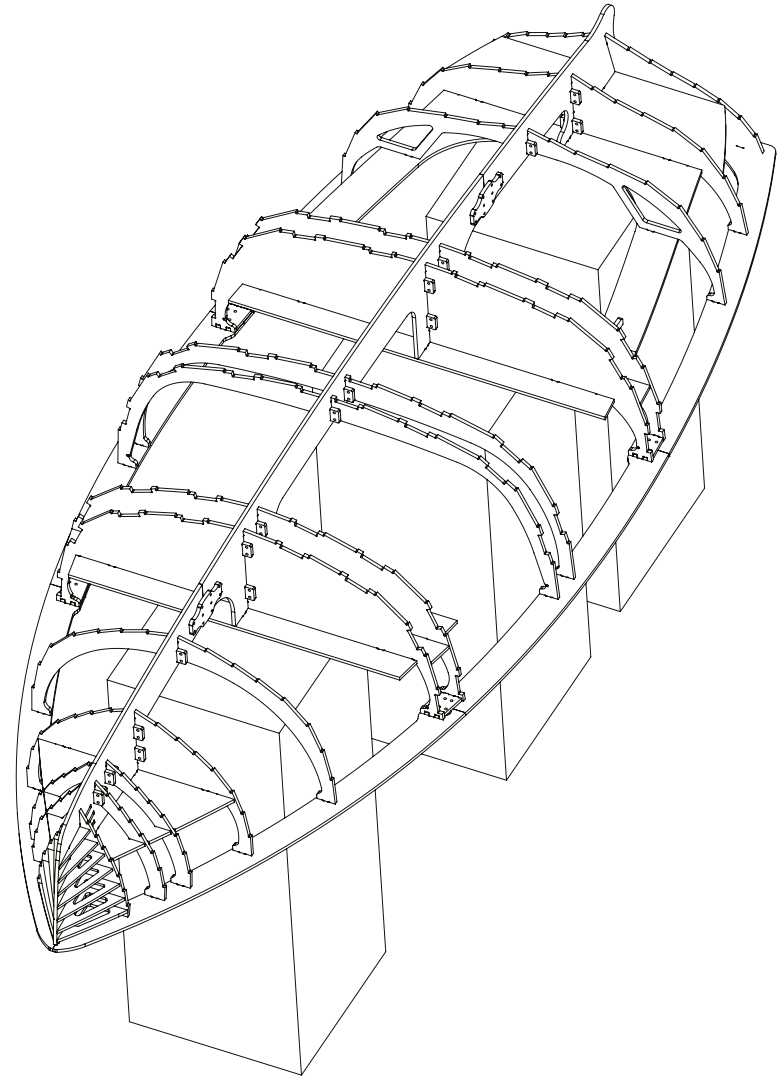
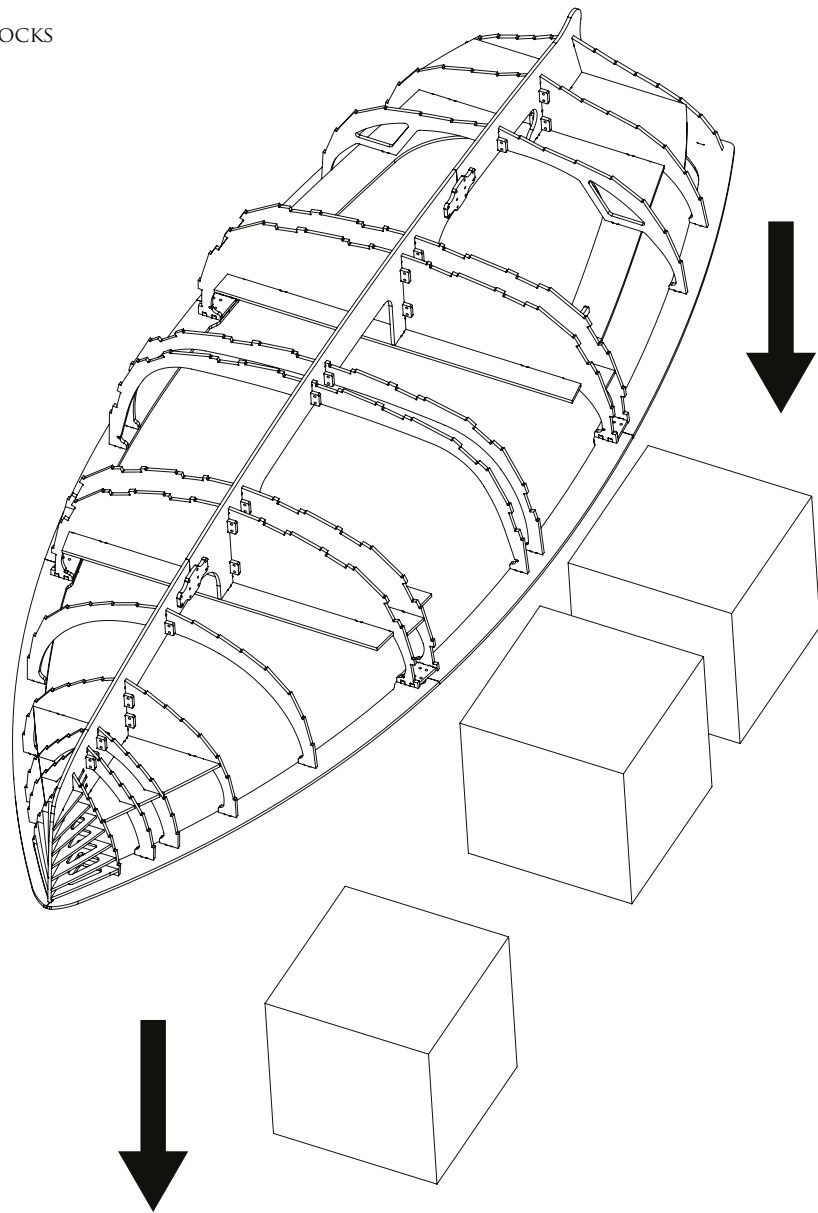

STEP 30

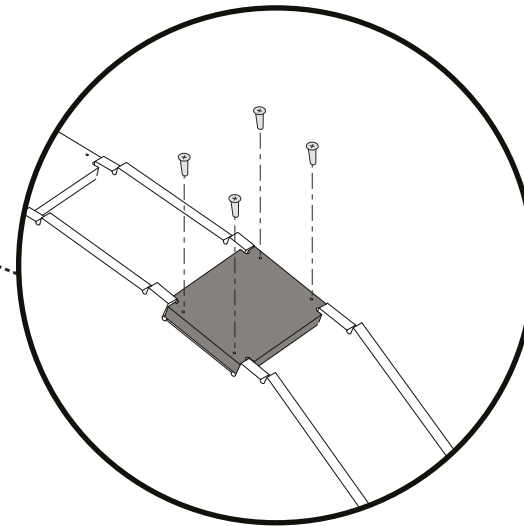
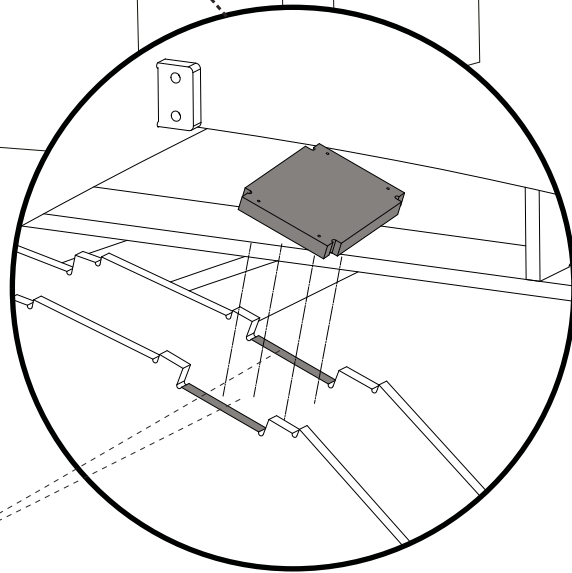
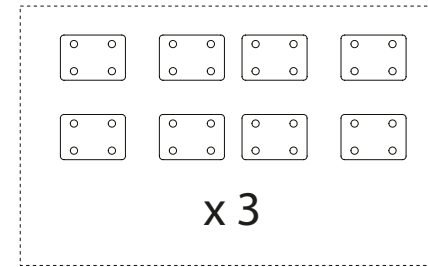
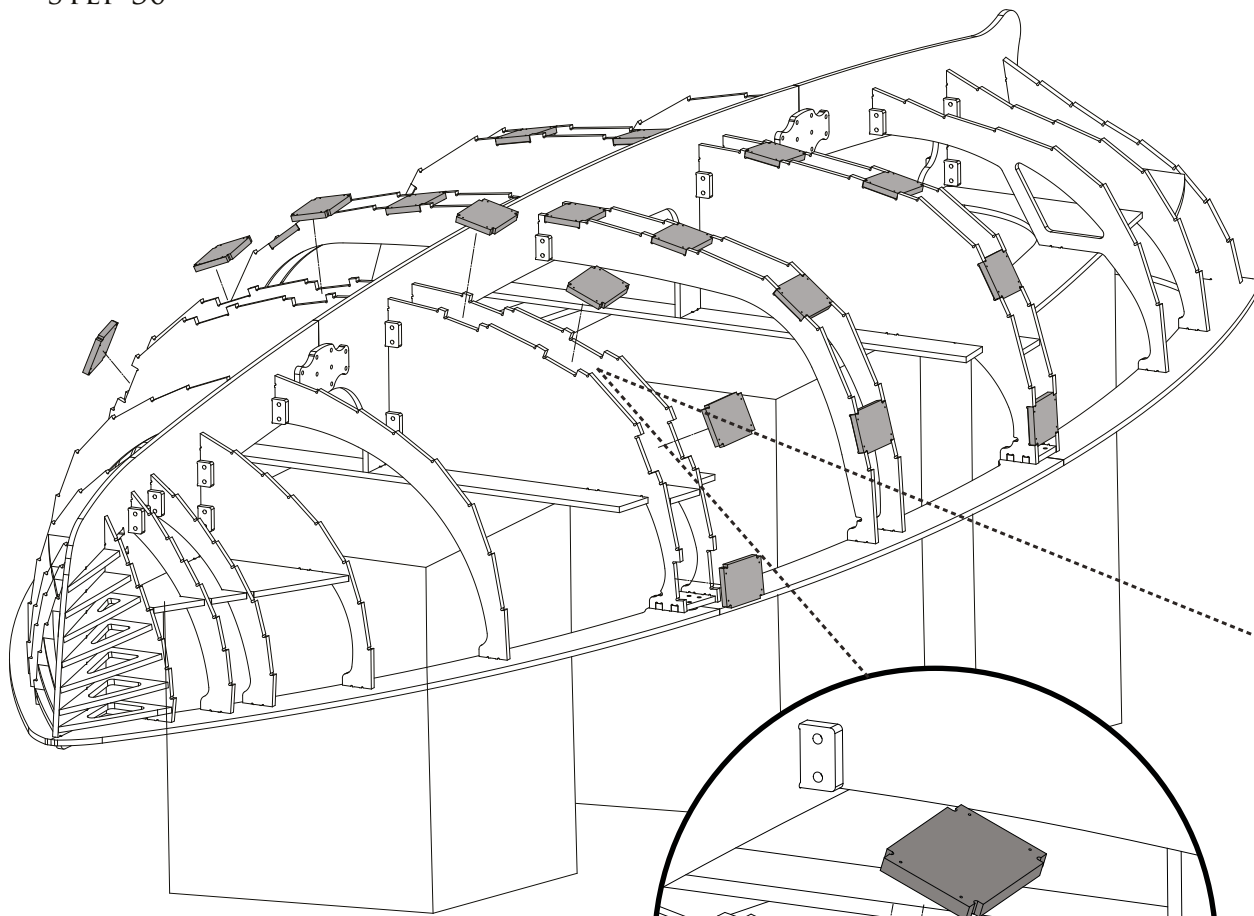

NOTE: APPLY GLUE TO DARK GREY AREAS

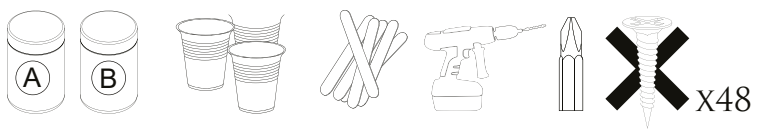

THE BALMAIN  
BOAT COMPANY

Please following in order of plank part numbers.

- 8-B → 8-A
- 7-C → 7-B → 7-A
- 6-B → 6-A
- 5-C → 5-B → 5-A
- 4-B → 4-A
- 3-C → 3-B → 3-A
- 2-B → 2-A
- 1-C → 1-B → 1-A

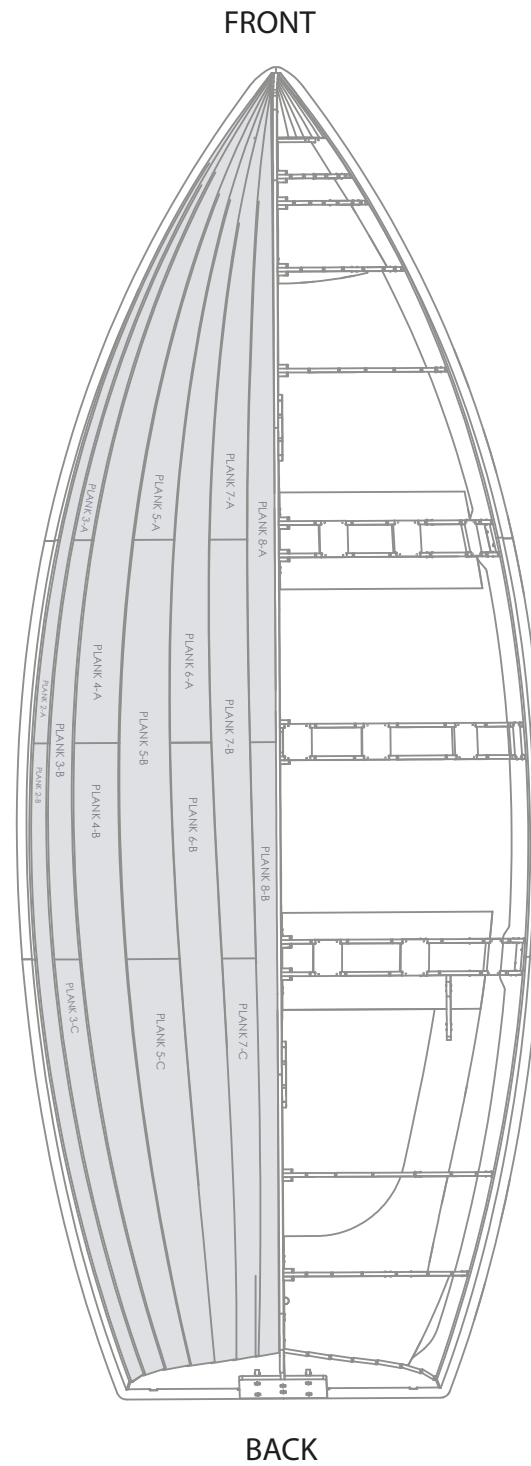
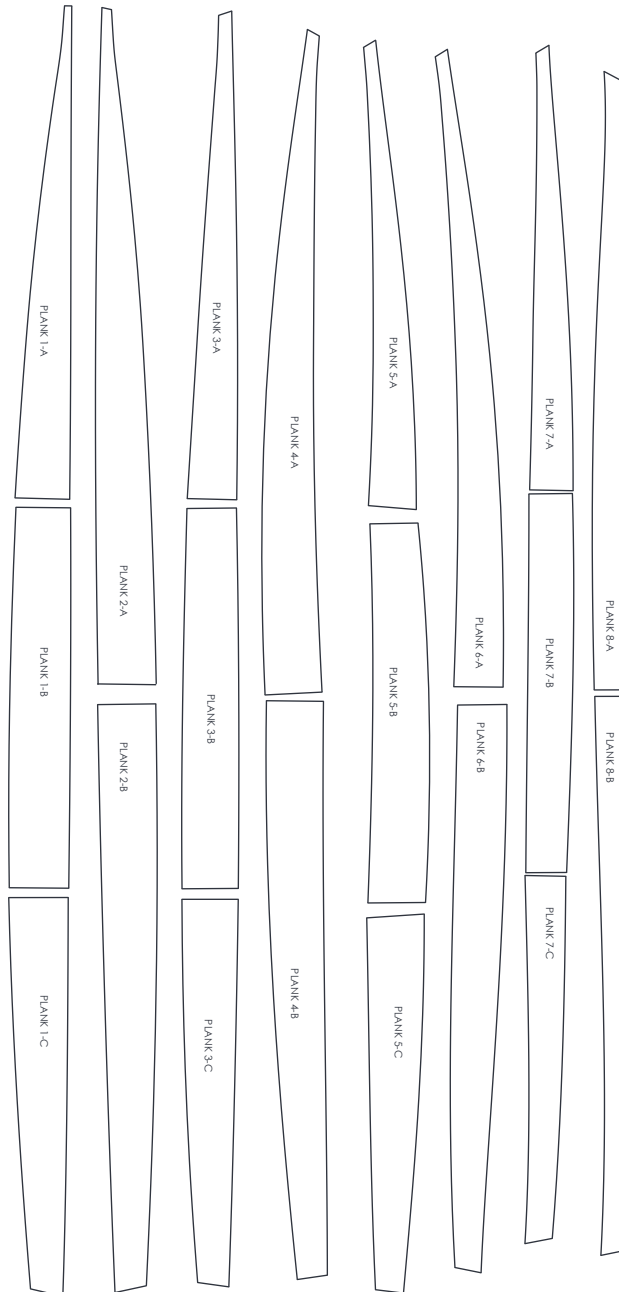

STEP 31

NOTE: USE 16MM SCREWS FOR PLANKS

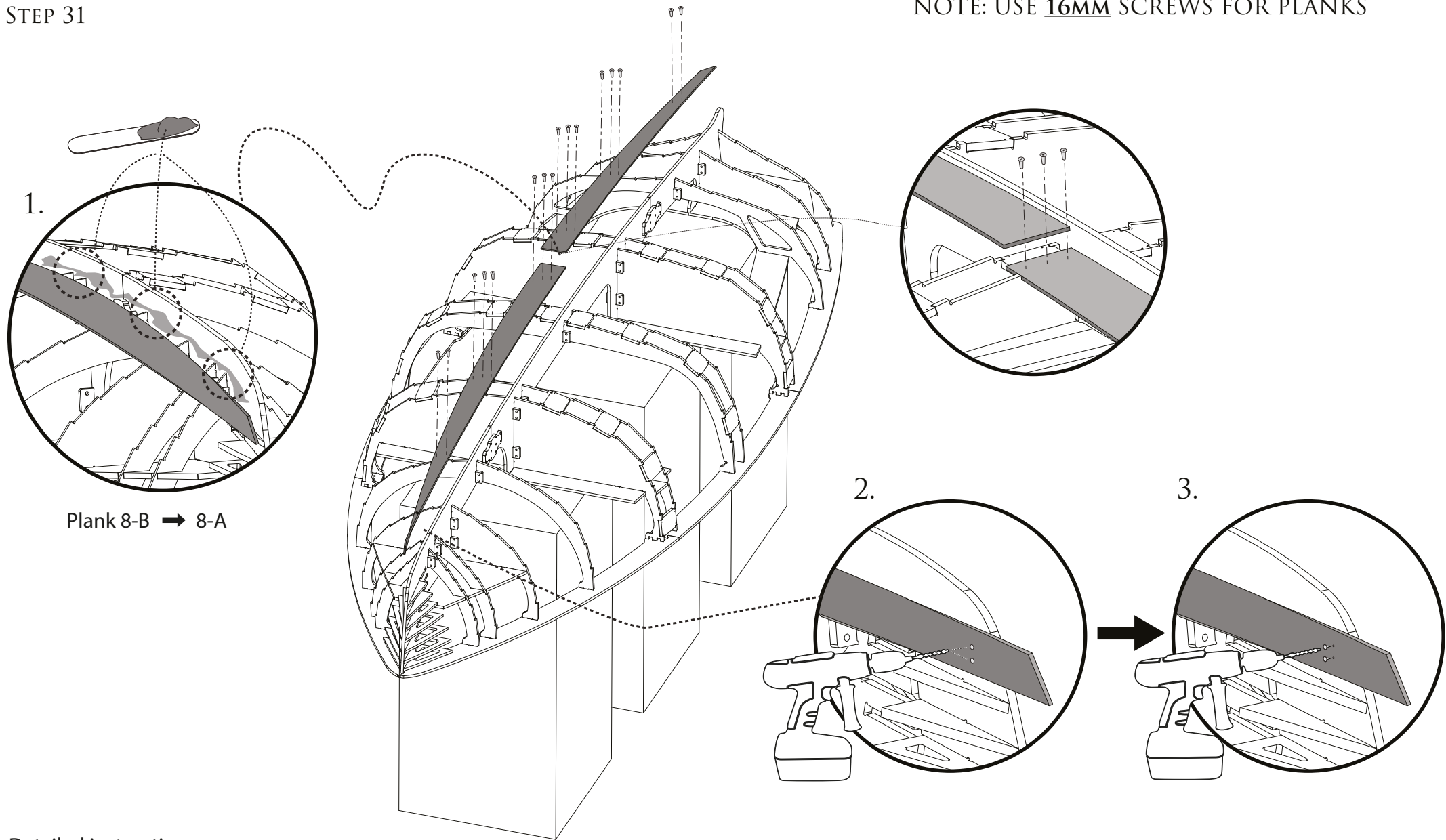

Detailed instructions:

1. Start each plank row from the BACK of the boat.
2. Line up plank ends so that it is square (make sure it is straight and in line with the with the rest of the boat)
3. Apply Glue along the plank
4. Drill 2 holes per rib
4. Screw on the "FOWARD KEEL" to finish a plank row



THE BALMAIN  
BOAT COMPANY



STEP 32

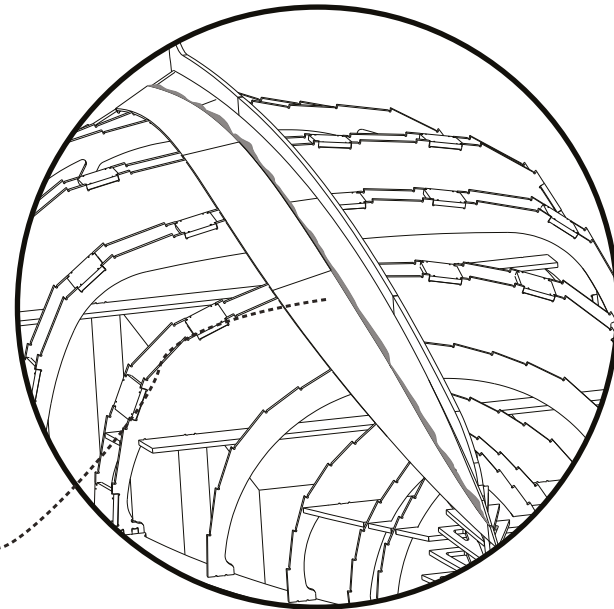
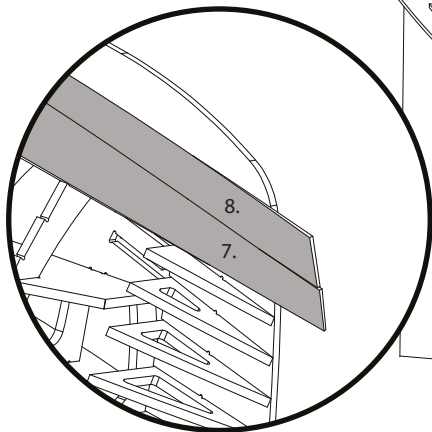
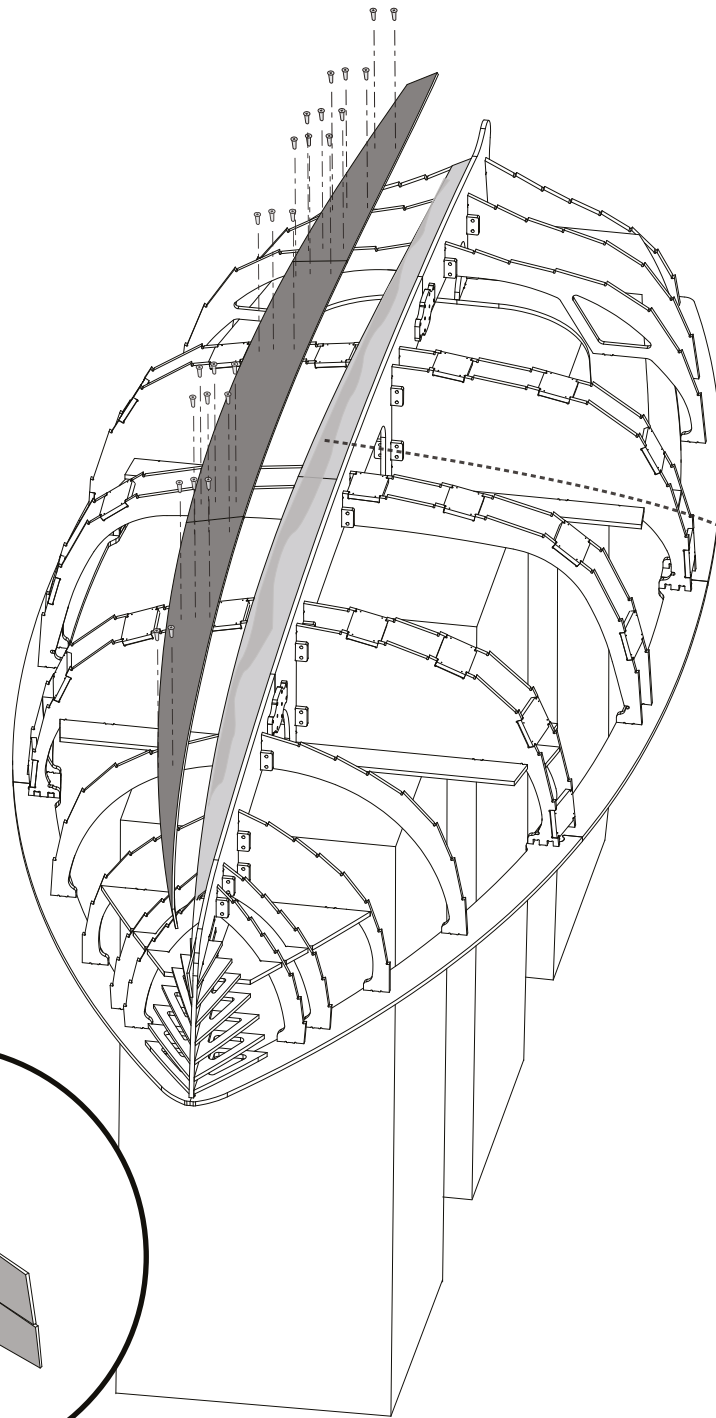

Glue Thoroughly on overlap, to ensure strength

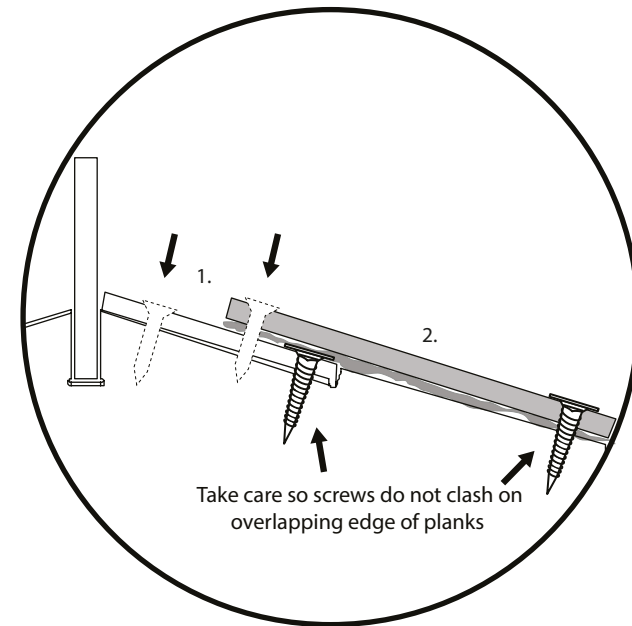



STEP 33

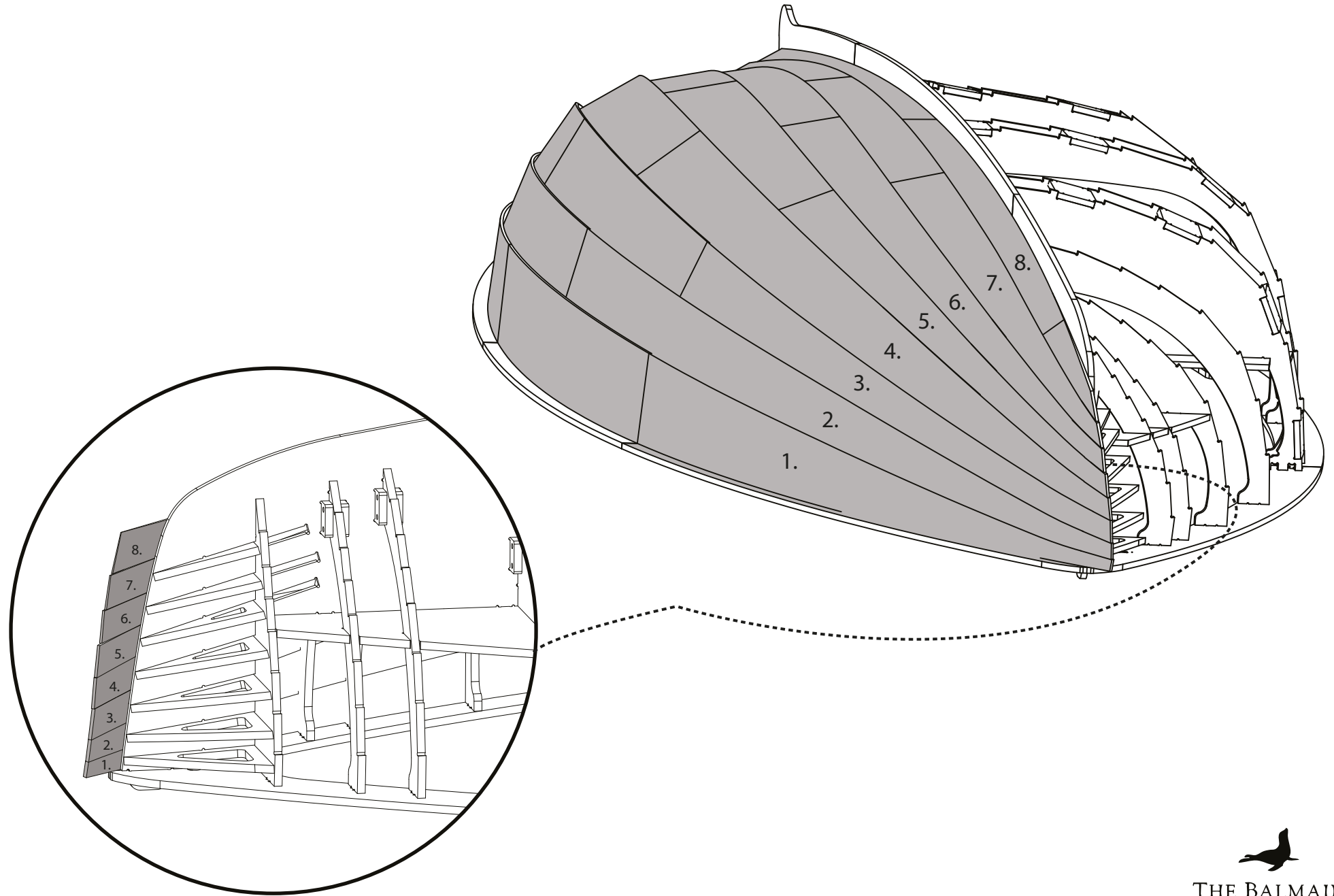

STEP 34

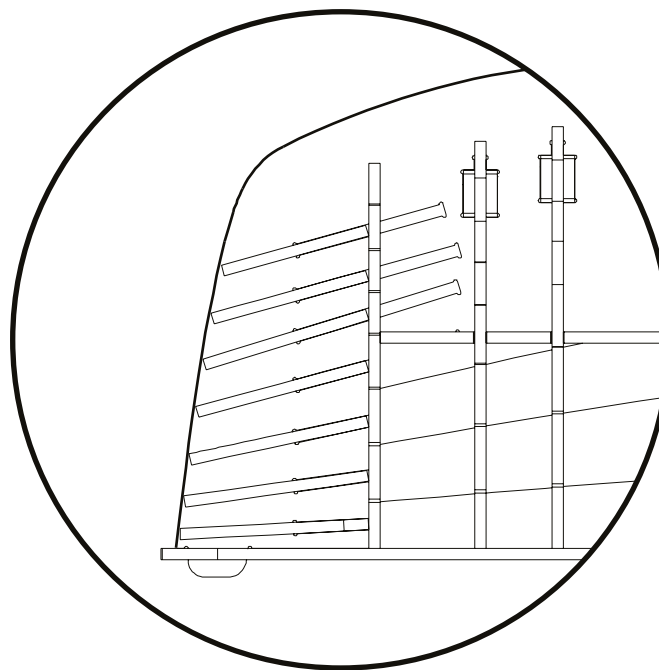
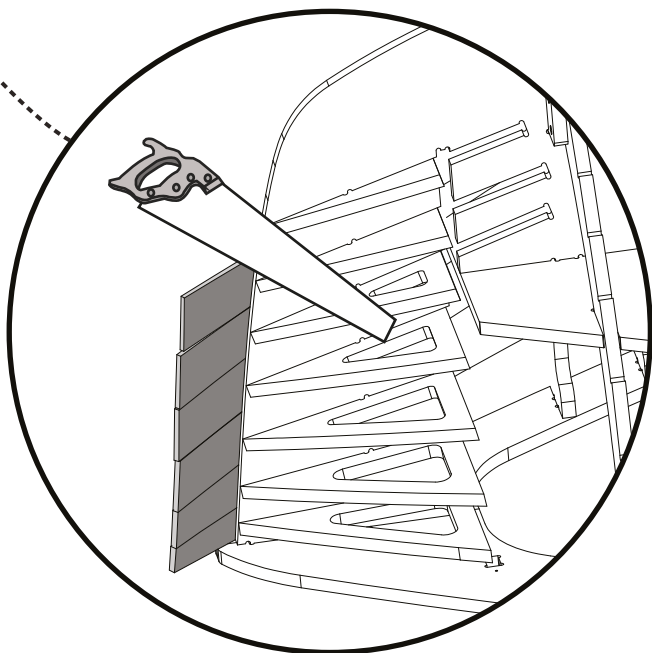
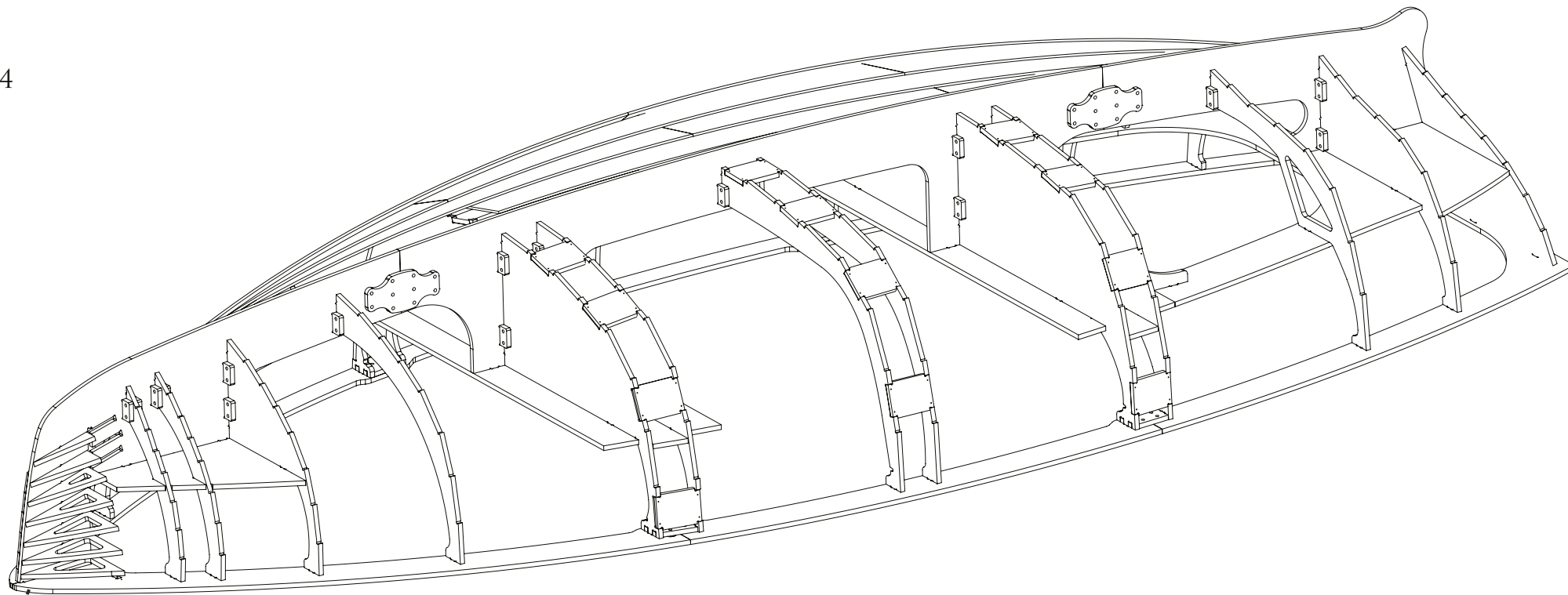

STEP 35

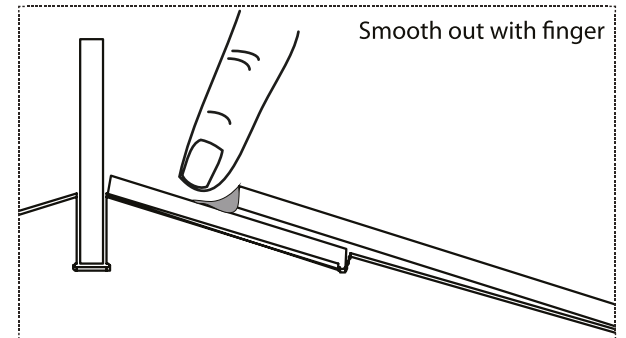
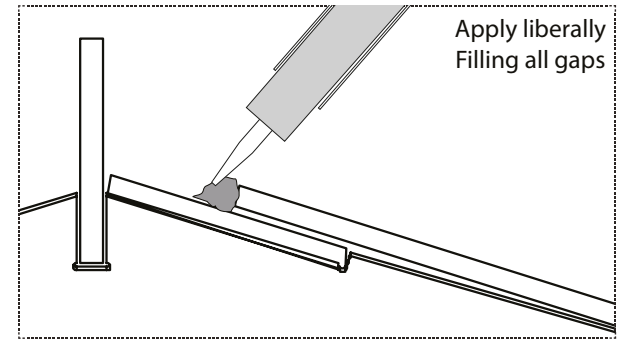
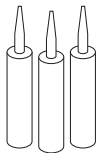
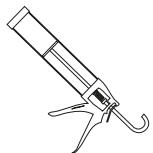
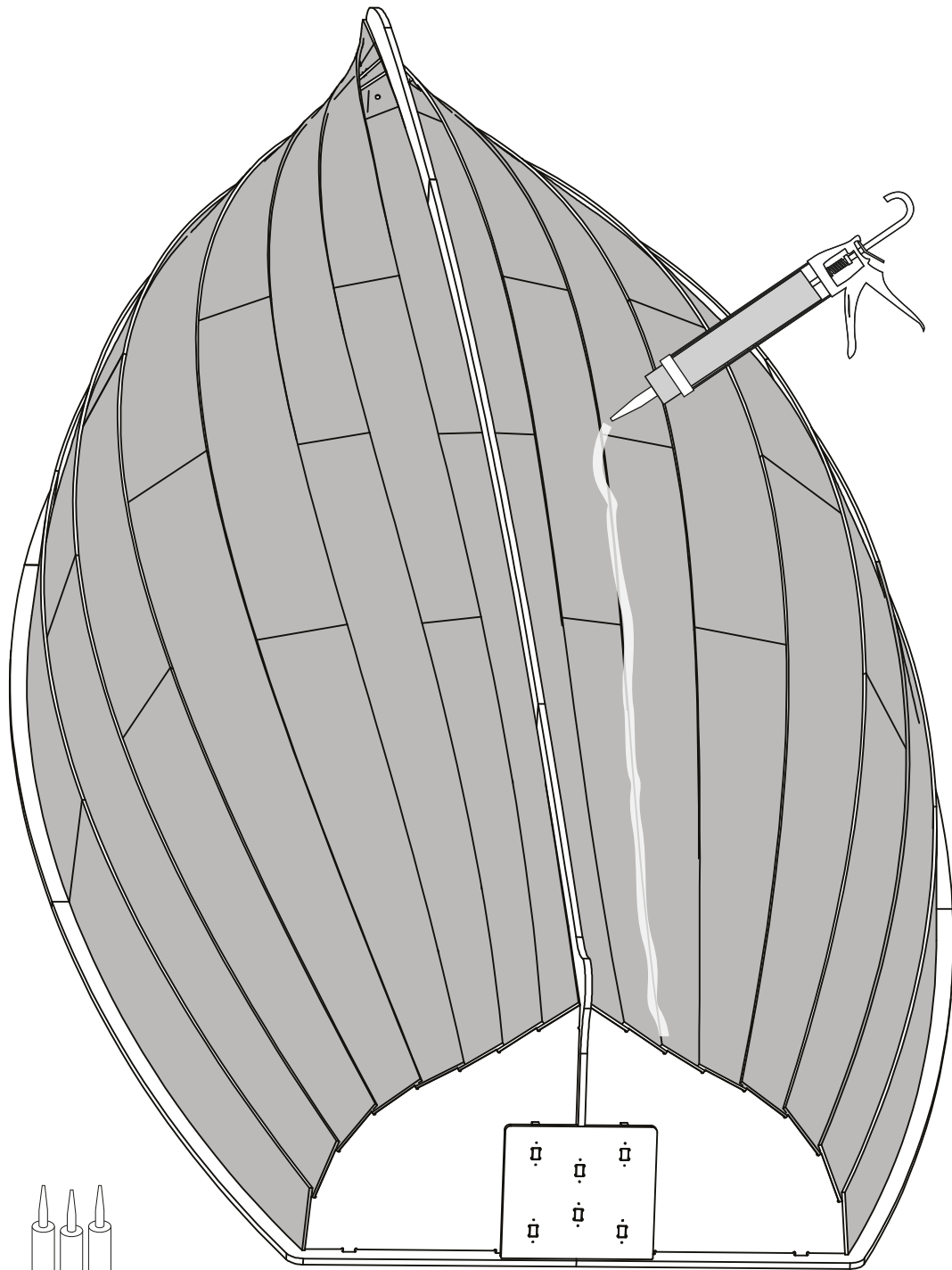

STEP 36

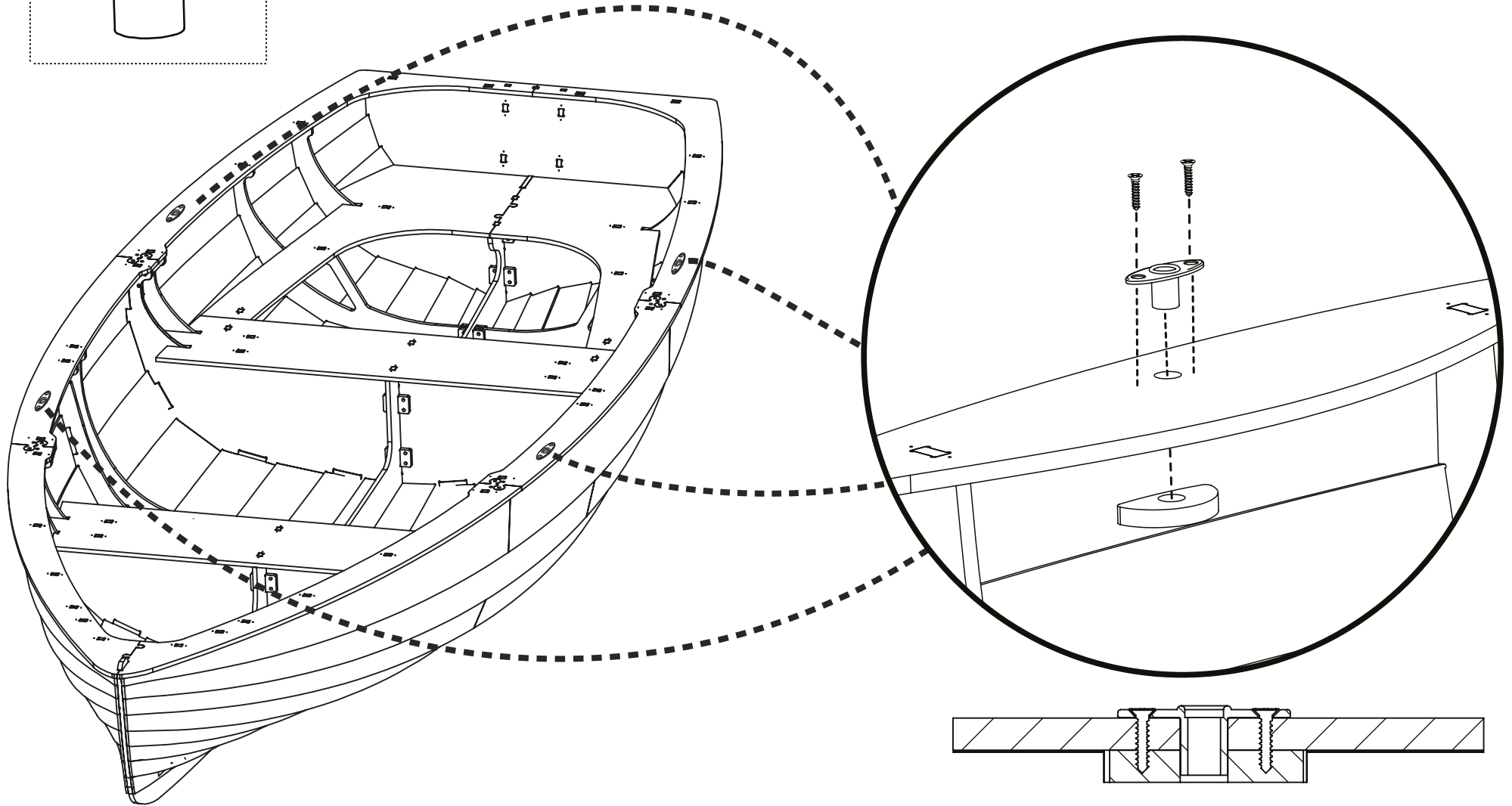
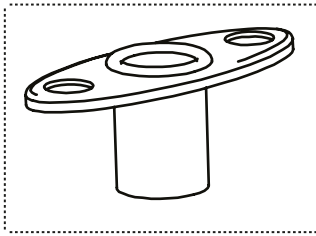

Detailed instructions:

1. Sit inside boat with oars resting on the washboards (note: sit facing the rear of the boat).
2. Find a comfortable position for them to rest, place a rowlock here and trace around the shaft with a pencil
3. Drill out material so that the rowlock shaft can pass through the washboard
4. Place timber rowlock support on underside of rowlock and secure with screws from the top side.
4. Repeat for all 4 positions of rowlocks

